



Fylde Borough Council
Fairhaven Lake Adventure Golf
10.01.2020



HELLO

WE ARE GREENSPAN

Established 1976, Greenspan Projects Ltd are a forward thinking, market focused company delivering creative design and build solutions to our clients by providing top level service from concept to completion.

Services to Tourism and Leisure include large bespoke construction and theming projects for Local authorities, Holiday Resorts, Zoos, Theme Parks, Farm Parks and many other visitor attractions across the UK.



WHO WE'VE WORKED WITH



FAIRHAVEN ADVENTURE GOLF – GENERAL ARRANGEMENT PLAN

Interpretation board titles:

- | | | | | | |
|----|--------------------------------|----|-------------------------------------|----|-------------------------------------|
| A. | Fylde in Bloom | F. | Mallard | K. | St Annes Old Links (9th Hole) |
| B. | Fairhaven Lake | G. | Singleton Fire Station | L. | Lytham Hall |
| C. | Curlew | H. | Oystercatcher | M. | Royal Lytham & St Annes (14th Hole) |
| D. | St Annes Old links (18th Hole) | I. | St Annes Pier | N. | Lytham Windmill |
| E. | Japanese Gardens | J. | Royal Lytham & St Annes (17th Hole) | O. | Redshank |



FAIRHAVEN ADVENTURE GOLF – Course Flow plan

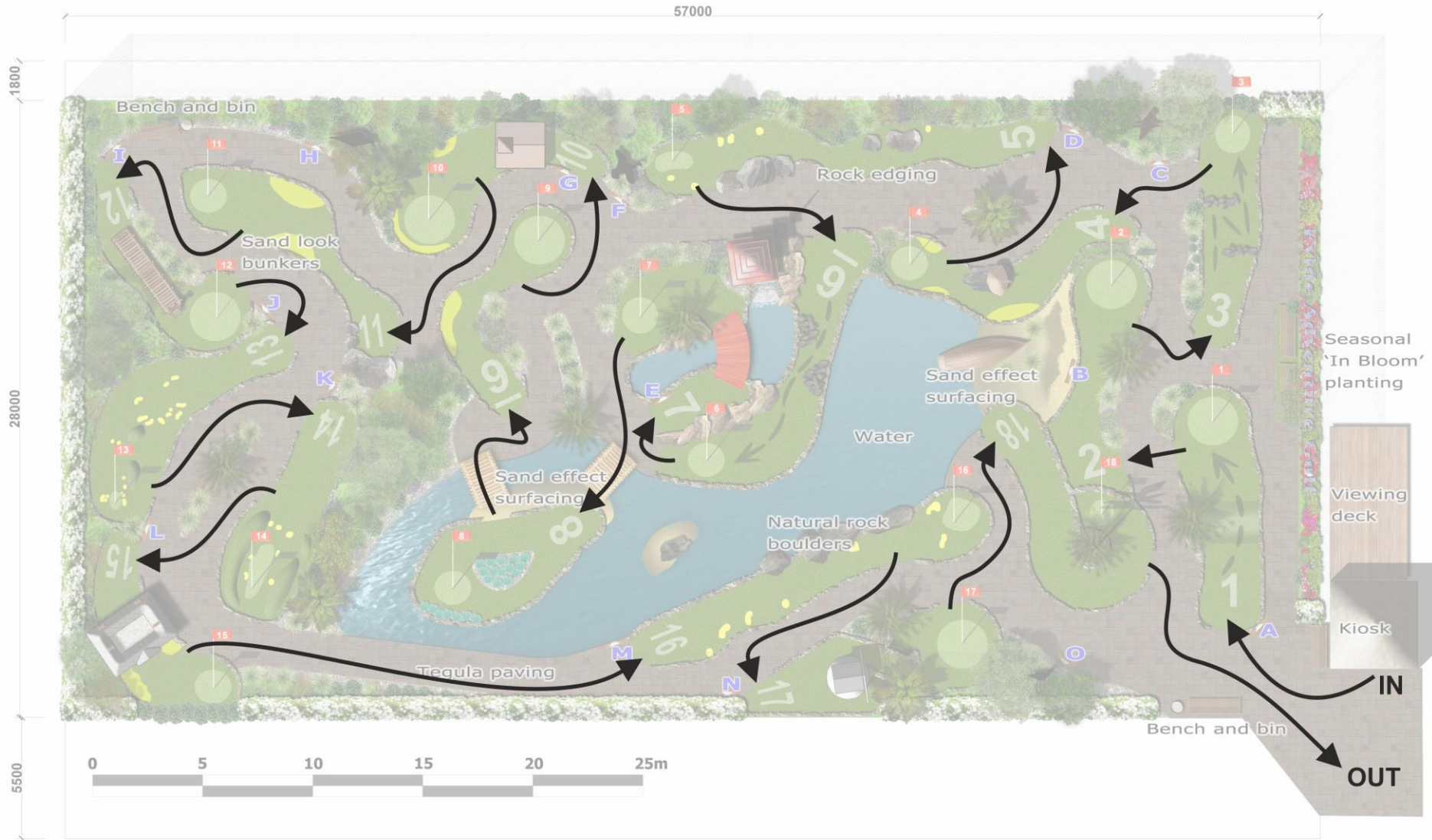

FAIRHAVEN ADVENTURE GOLF – St Annes Old Links Course – Hole layouts

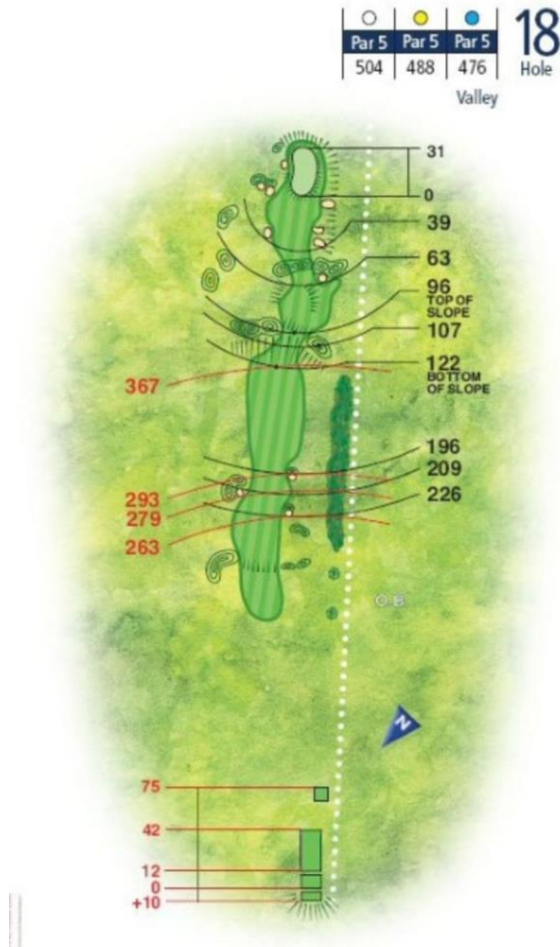

FAIRHAVEN ADVENTURE GOLF – Royal Lytham & St Anne's – Hole layouts

Description

The landing area from the tee is intimidatingly small on this well bunkered fairway. The hole turns left towards an open green protected by bunkers on either side. Don't miss the plaque by the third drive bunker to the left of the fairway - it commemorates the famous second shot of Bobby Jones in the final round of the 1926 Open.

17th Hole



Bobby Jones plaque
On the 17th



14th Hole



FAIRHAVEN ADVENTURE GOLF – Design inspiration reference images

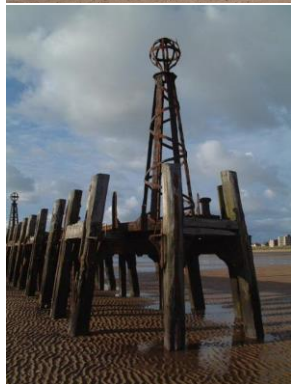

FAIRHAVEN ADVENTURE GOLF – GENERAL ARRANGEMENT – PLANT LIST

Indicative Plant schedule Species

Size & Spec.

Trees

Arbutus unedo	10-12 RB 2.75-3m
Betula lenta	12-14 RB 3-3.5m
Cordylone australis	C25 central main leader
Crataegus laevigata 'Pauls Scarlett'	12-14 RB 3-3.5m
Ilex aquifolium	2-2.5m height RB
Malus 'Royal Beauty'	12-14 RB 3-3.5m
Pinus pinea	3-3.5m height RB
Quercus ilex	12-14 RB 3-3.5m
Sorbus aria 'Lutescens'	12-14 RB 3-3.5m
Sorbus aucuparia fastigiata	12-14 RB 3-3.5m
Sorbus intermedia	12-14 RB 3-3.5m
Pinus mugo	C25, 1-1.2m

Hedges

Escallonia 'Apple Blossom'	C10, 1-1.2m
Griselinia littoralis	C10, 1-1.2m

Shrubs

Betonica officinalis	C3 20-30
Brachyglottis 'Sunshine'	C5 30-40
Cotoneaster salicifolius	C10 30-40
Cytisus × kewensis	C5 30-40
Elaeagnus 'Limelight'	C5 30-40
Euonymus 'Green Rocket'	C3 20-30
Fuchsia magellanica 'Versicolor'	C5 30-40
Genista lydia	C5 30-40
Lavandula angustifolia 'Hidcote'	C3 20-30
Olearia × haastii	C5 30-40
Phlomis chrysophylla fruticosa	C3 20-30
Phormium Maori Queen	C10 70-80
Phormium tenax	C10 70-80
Stachys byzantina 'Silver Carpet'	C3 20-30

Ornamental Grasses

Miscanthus 'Yakushima Dwarf'	C5 30-40
Sesleria caerulea	C5 30-40
Miscanthus sinensis 'Variegatus'	C5 30-40
Molinia caerulea 'Heidebraut'	C5 30-40
Panicum virgatum 'Prairie Sky'	C5 30-40
Miscanthus sinensis	C5 30-40

Perennials

Achillea millefolium	C1, well developed
Armeria maritima 'Alba'	C1, well developed
Armeria maritima	C1, well developed
Artemisia 'Boughton Silver'	C1, well developed
Crambe maritima	C1, well developed
Echinacea purpurea 'Ruby Giant'	C1, well developed
Eryngium bourgatii 'Picos Blue'	C1, well developed
Hylotelephium spectabile	C1, well developed
Iris spp.	C1, well developed
Kniphofia spp	C1, well developed
Limonium platyphyllum 'Violetta'	C1, well developed
Salvia lavandulifolia	C1, well developed
Veronicastrum 'Pink Glow'	C1, well developed

Interpretation board titles:

A. Fylde in Bloom	F. Mallard	K. St Annes Old Links (9th Hole)
B. Fairhaven Lake	G. Singleton Fire Station	L. Lytham Hall
C. Curlew	H. Oystercatcher	M. Royal Lytham & St Annes (14th Hole)
D. St Annes Old links (18th Hole)	I. St Annes Pier	N. Lytham Windmill
E. Japanese Gardens	J. Royal Lytham & St Annes (17th Hole)	O. Redshank

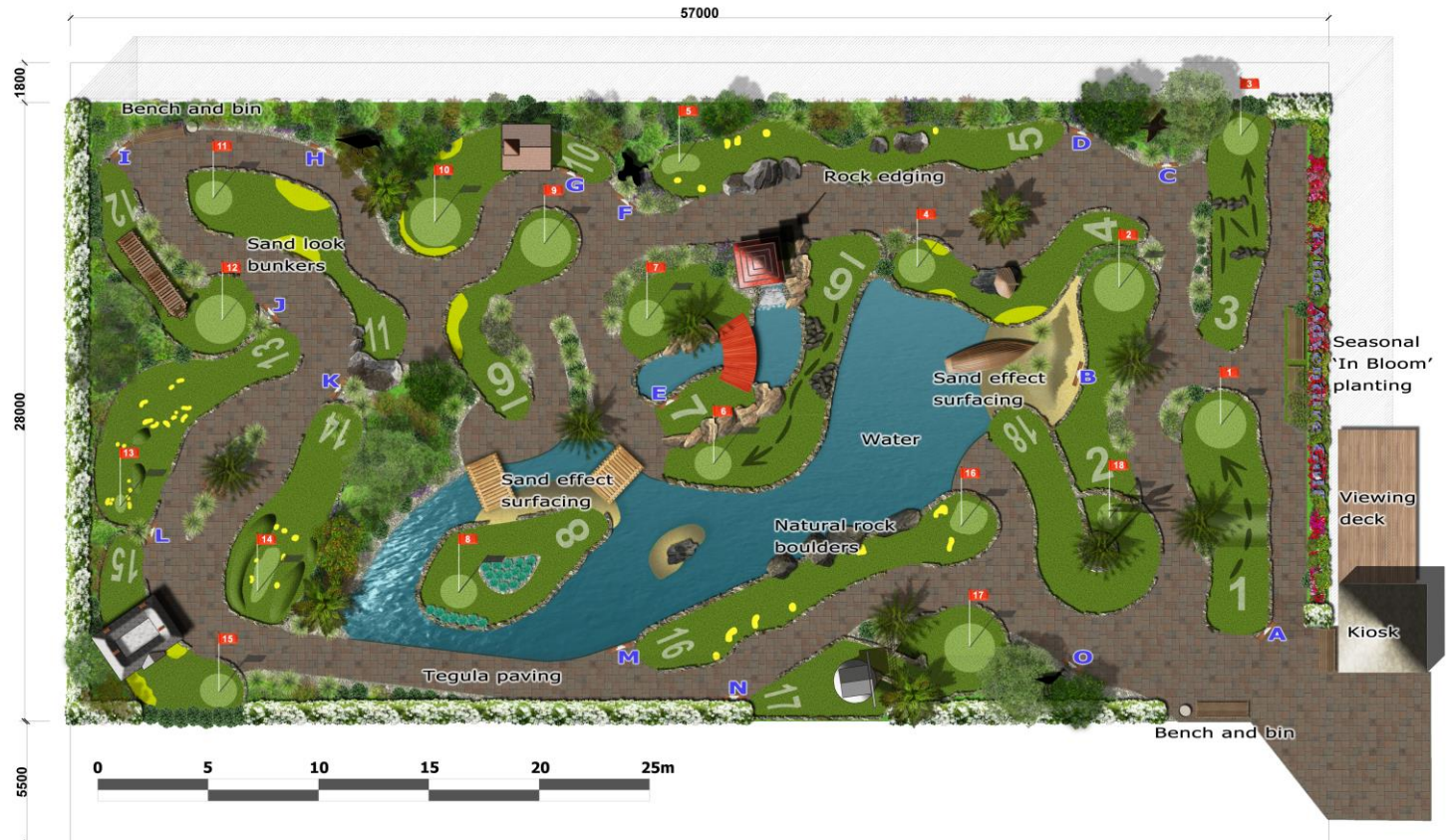

Appendix A – Greenspan Projects Design Submission Documents

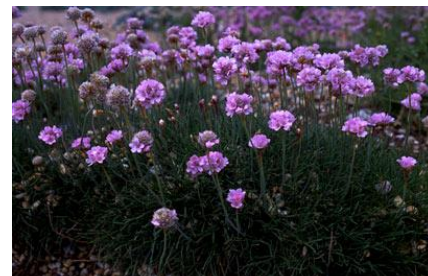

Appendix A – Greenspan Projects Design Submission Documents

FAIRHAVEN ADVENTURE GOLF – Landscape & Planting Scheme



FAIRHAVEN ADVENTURE GOLF – Artists impression 3D visualisation



Fylde BC – Fairhaven Lake

FAIRHAVEN ADVENTURE GOLF – Example Hole design & playability



HOLE

7

PAR 4

FAIRHAVEN ADVENTURE GOLF – Example Hole Design

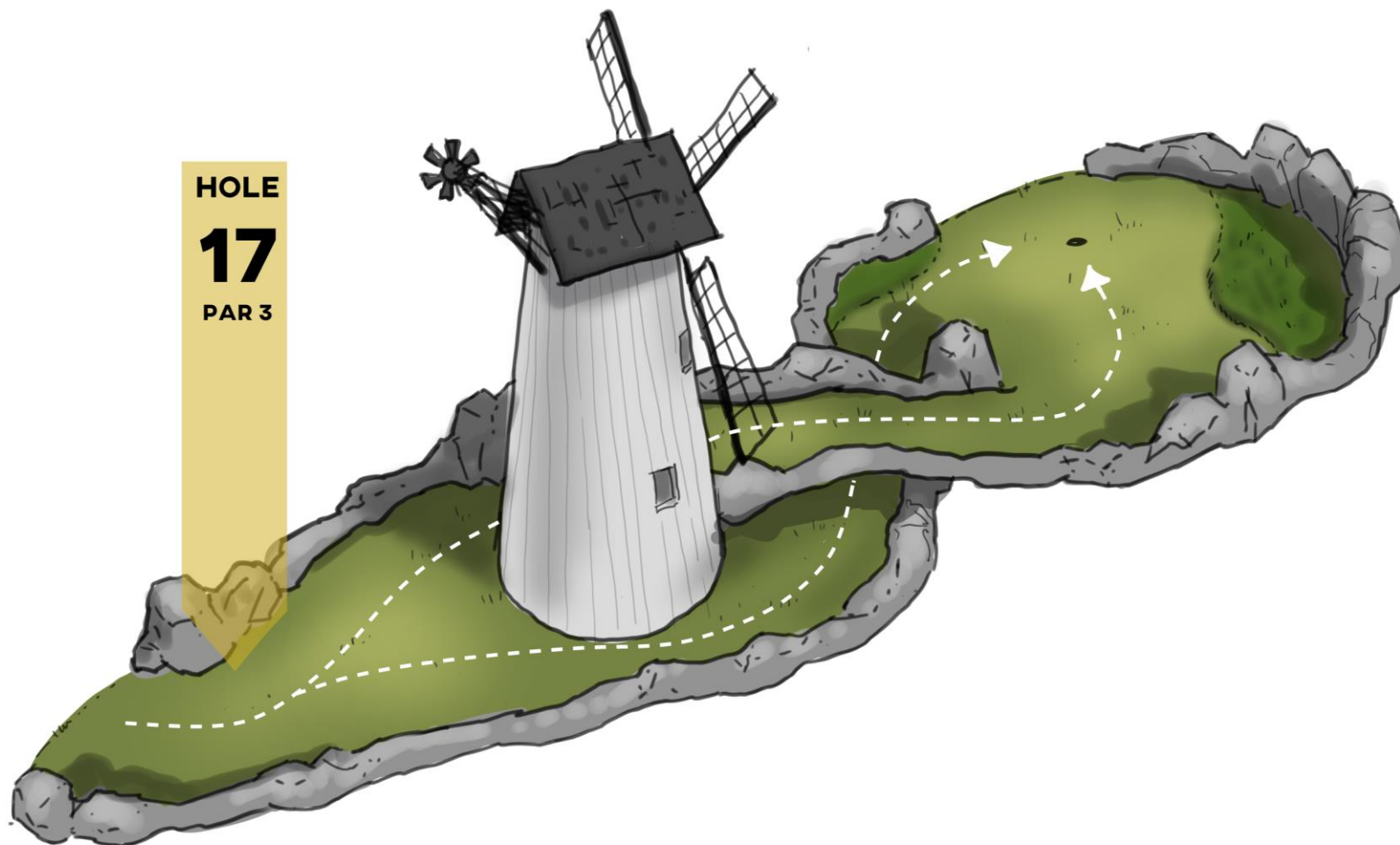

FAIRHAVEN ADVENTURE GOLF – Example Hole Design

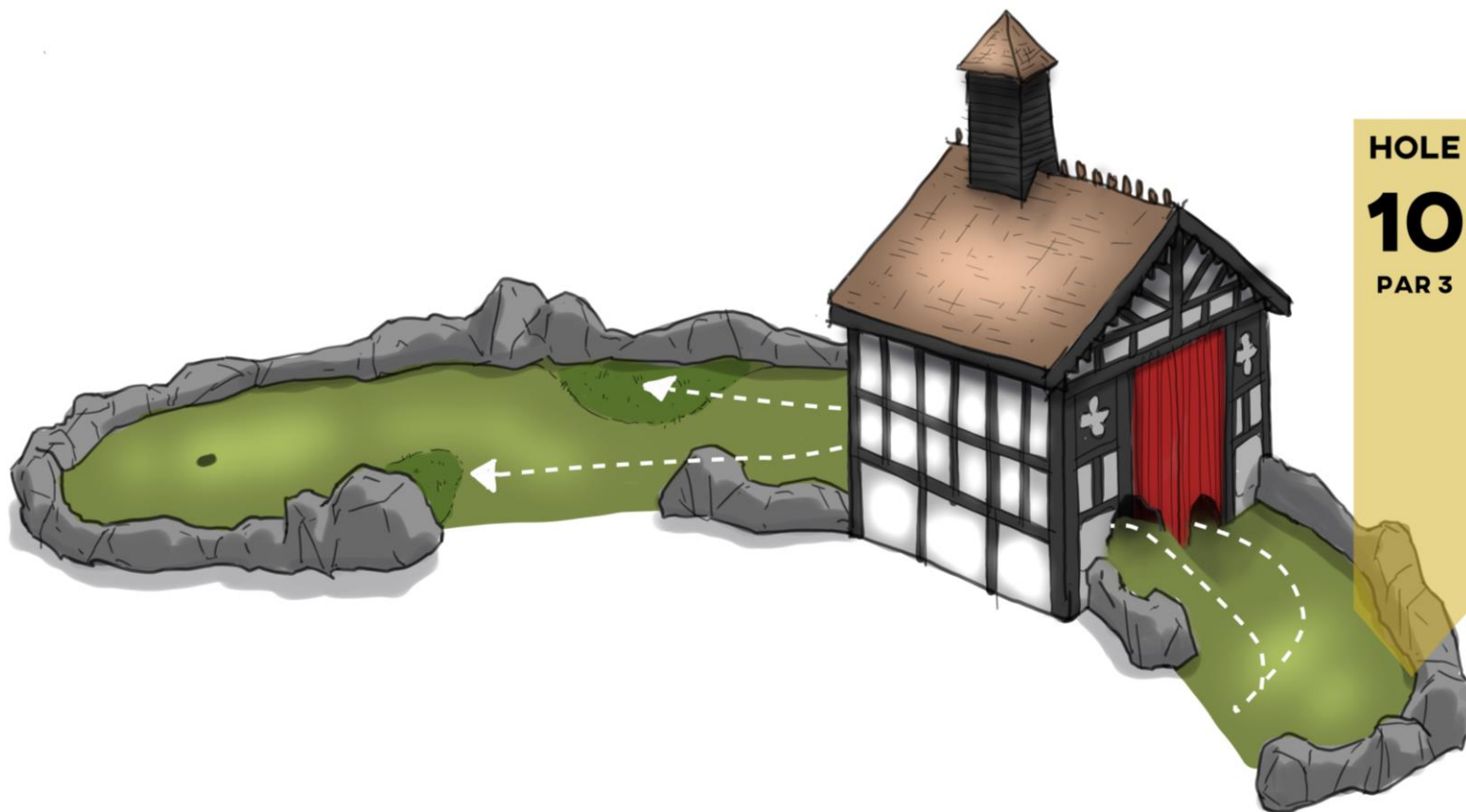

WHAT OUR CLIENTS SAY...

“When we first asked Greenspan to look to develop our new outdoor play area, they came out to listen to our ideas and went away and drew up 3D drawings incorporating our thoughts along with original ideas of their own. We chose to use Greenspan because they seemed like a firm we could work with, nothing was too much trouble. The result is we have a fantastic play area called Topsy Turvey Towers which is unique to us and the build quality is second to none.

Owner | Mead Open Farm

”

Greenspan have undertaken a number of projects in the Park including a themed play area, bespoke elevated timber boardwalk with treetop classroom. Whilst each project has provided its unique challenges and complications we have been very impressed with Greenspan's ability to adapt, think outside the box and work to our (tight) deadlines and often specialist requirements. Greenspan work in well with our own site management procedures, and their staff are co-operative and willing to work alongside our own staff when required to do so.”

Building Projects Manager | Marwell Wildlife

"I just want to let you know that we have been very pleased with the team you have sent to Chessington over the past few weeks, they've fitted in well with our own team here. They have been very professional, worked hard, carried out all they've been asked to do and produced great results during this busy time for us. Please pass on my thanks to Phil, Anthony, Bradley, Gregg, William, Ben and Jez for their hard work, help and support."

Landscape Manager | Chessington World of Adventure

“Greenspan have demonstrated a real ability to coordinate both the pre-visualisation and construction of complex projects to a defined budget... allowing us to get a clear understanding of what the eventual product would look like and security that the concepts could be afforded at an early stage. Their project management and on-site teams are especially diligent and worked hard to satisfy our requirements”

Project Manager | Merlin Entertainments



ACCREDITATIONS & PARTNERS





Greenspan Projects Ltd | A: Milkmead Farm | Hogwood Lane
West End | Southampton | SO30 3HZ
T: 023 8047 6737 | E: sales@greenspanltd.com | W: www.greenspanltd.com