

Agenda

Licensing Hearing

Date:	Friday, 20 October 2023 at 10:30 am
Venue:	Town Hall, St Annes, FY8 1LW
Committee members:	Councillor Sue Fazackerley MBE (Convenor) Councillor Sandra Pitman Councillor Noreen Griffiths Councillor Frank Andrews (Reserve)

	PROCEDURAL ITEMS:	PAGE
1	Declarations of Interest: Declarations of interest, and the responsibility for declaring the same, are matters for elected members. Members are able to obtain advice, in writing, in advance of meetings. This should only be sought via the Council's Monitoring Officer. However, it should be noted that no advice on interests sought less than one working day prior to any meeting will be provided.	1
2	Procedure for the Conduct of Hearings	3-4
3	Application for the Grant of a Premises Licence - Craft and Common, 45 Woodlands Road, Ansdell	5 - 38

Contact: Democracy - Telephone: (01253) 658546 – Email: democracy@fylde.gov.uk

The code of conduct for members can be found in the council's constitution at
<http://fylde.cmis.uk.com/fylde/DocumentsandInformation/PublicDocumentsandInformation.aspx>

© Fylde Council copyright 2023

You may re-use this document/publication (not including logos) free of charge in any format or medium. You must re-use it accurately and not in a misleading context.

The material must be acknowledged as Fylde Council copyright and you must give the title of the source document/publication.

Where we have identified any third party copyright material you will need to obtain permission from the copyright holders concerned.

This document/publication is also available on our website at www.fylde.gov.uk

Any enquiries regarding this document/publication should be sent to us at the Town Hall, St Annes Road West, St Annes FY8 1LW, or to listening@fylde.gov.uk.



LICENSING ACT 2003

THE LICENSING ACT 2003 (HEARINGS) REGULATIONS 2005

PROCEDURE FOR THE CONDUCT OF HEARINGS

1. *Preliminary*

- 1.1. Under the regulations, the Licensing Authority is required to determine the procedure that it proposes to follow at any hearing under the Act. This document sets out the procedure that Fylde will normally follow.
- 1.2. A panel may decide to follow a different procedure at any hearing. If it does, it will specifically draw attention to any departures from the procedures set out in this document and the reasons for them.
- 1.3. Please refer to the regulations for other rules about procedure

2. *Interpretation*

In this procedure, the following words or phrases have the following meanings:

applicant	an applicant for a licence or any person who has a licence which may be reviewed or revoked as a result of the hearing
act	The Licensing Act 2003
licence	Includes any consent or permission under the act
panel	A sub-committee established by Fylde Borough Council under section 10 of the act
regulations	The Licensing Act 2003 (Hearings) Regulations 2003, and any reference to a numbered regulation is to the regulation so numbered in that statutory instrument
witness	A person given permission to appear at the hearing under regulation 8(2)

3. *Before the hearing*

- 3.1. At least ten days before the hearing, the panel will meet to consider:
 - 3.1.1. If the circumstances set out in regulation 9(1) apply, whether to dispense with holding a hearing;
 - 3.1.2. What, if any, particular points it considers it will want clarification on at the hearing from a party under regulation 7(1)(d), and
 - 3.1.3. What time limit to set under regulation 24.
- 3.2. If it is not practicable for the panel to meet to consider these matters, the convenor may ascertain the views of panel members separately and give effect to the majority view as if it had been reached in a meeting of the panel.

4. *Opening the hearing*

- 4.1. The convenor will identify all parties to the hearing who are present. The convenor will also identify any persons who are present who intend to assist or represent any party and any witnesses.
- 4.2. The legal officer will then explain to the parties the procedure to be followed at the hearing, specifically drawing attention to any departures from the procedures set out in this document and the reasons for them. The legal officer will also inform the parties that the proceedings will be recorded.
- 4.3. The panel will then consider any request by a party under regulation 8(2) for another person to appear at the hearing. The convenor will give any party who has made such a request (or their representative) which the panel proposes to deny an opportunity to address the panel about their request. The panel will then re-consider the request.
- 4.4. The convenor may invite any officer to carry out any functions under this paragraph.

5. *Listening to the parties*

- 5.1. Each of the parties will then be invited to:
 - 5.1.1. Open their case by addressing the panel;
 - 5.1.2. Give any further information requested by the panel under regulation 7(1)(d);
 - 5.1.3. Present the evidence of any witness; and
 - 5.1.4. Conclude their case by addressing the panel.
- 5.2. The order in which the parties will be invited to put their cases will be in the discretion of the panel, except that a party who is an applicant will be invited to put their case last.

6. *Questioning the parties*

- 6.1. Members of the panel may, following the conclusion of the case of each party, ask questions of that party or any witness appearing for them.
- 6.2. A party or their representative may only question another party if they have asked for permission from the panel after the panel members have finished questioning that party or their witness. The panel will only give permission if it is satisfied that the questioning will provide useful information about a matter relevant to their determination which is unlikely to be placed before the panel without such questioning

7. *Time limits*

Each party will be limited to the time set by the panel under regulation 24 in which to exercise their rights provided in paragraphs 5 and 6.2. The convenor will require the party or their representative to close their case or cease their questioning immediately this time limit is reached.

8. *Considering the decision*

- 8.1. The hearing will conclude after all parties have presented their case and responded to any questions. The panel will then deliberate on its decision by whatever means it considers to be appropriate. The panel will consider their decision in private.
- 8.2. The panel may, while it is considering its decision, seek advice from legal or licensing officers, either verbally or in writing. Officers will limit their advice to the specific issue identified by the panel
- 8.3. When the panel has reached its decision, it may ask the legal, licensing or committee officers to review and offer observations on the draft decision notice.

9. *Communicating the decision*

- 9.1. The decision will be sent in writing to all parties in accordance with the regulations.

DECISION ITEM

REPORT OF	MEETING	DATE	ITEM NO
HEAD OF ENVIRONMENTAL AND HOUSING SERVICES	LICENSING HEARING	20 OCTOBER 2023	3
APPLICATION FOR THE GRANT OF A PREMISES LICENCE CRAFT AND COMMON, 45 WOODLANDS ROAD, ANSDELL			

PUBLIC ITEM

This item is for consideration in the public part of the meeting.

RELEVANT LEAD MEMBER

This item is within the remit of Lead Member for Social Wellbeing (Councillor Chris Dixon).

PURPOSE OF THE REPORT

The Licensing Authority has received an application for the grant of a premises licence for Craft and Common, 45 Woodlands Road, Ansdell. There have been representations from “other persons” as defined by the Act and as such a hearing must be held to determine the application.

RECOVERABILITY

This decision is not recoverable because it relates to a decision relating to the determining of any approval, consent, license, permission or registration.

RECOMMENDATION

That the Panel considers the application and determines to either:

- a) grant the application subject to the conditions specified in the operating schedule modified to such extent as the panel considers appropriate for the promotion of the licensing objectives, and any mandatory condition,
- b) exclude from the scope of the licence any of the licensable activities to which the application relates,
- c) Refuse to specify the person in the licence as a premises supervisor,
- d) reject the application.

REPORT

APPLICATION

1. The application is for a new premises licence, specifically for on sales of alcohol at 45 Woodlands Road, Ansdell.
2. The matter has been referred to the licensing panel because relevant representations have been received from “other persons” as defined by the Act.

PAPERS

3. The following papers are relevant and have been made available to the panel members:
 - The Application, including the plan and the Operating Schedule
 - The Statutory Guidance for Licensing Authorities issued by the Secretary of State under Section 182 of the Licensing Act 2003
 - The Council's Statement of Licensing Policy
 - Copies of relevant representations made by the following responsible authorities:
 - None received
 - Copies of Relevant Representations made by the following interested parties
 - R Barclay
 - J Cash
 - R Ellison

CONSIDERATION

4. The Licensing Objectives are:
 - The prevention of crime and disorder
 - Public Safety
 - The prevention of public nuisance
 - The protection of children from harm
5. As relevant representations have been made, it is the duty of the panel to take such of the steps set out below as it considers appropriate for the promotion of the licensing objectives. The steps are –
 - a) Grant the variation application subject to the conditions specified in the operating schedule modified to such extent as the panel considers appropriate for the promotion of the licensing objectives and any mandatory conditions;
 - b) Exclude from the scope of the licence any of the licensable activities to which the application relates
 - c) Reject the application
6. The Guidance issued by the Secretary of State and the Council's Statement of Licensing Policy will be material in considering the application, but cannot override the licensing objectives.
7. The following parts of the Secretary of State's guidance appear to be particularly relevant to the application and the relevant representations:
 - 2.15 Public Nuisance
 - 8.13 Other persons
 - 9.31 Hearings
 - 9.42 Determining actions that are appropriate for the promotion of the licensing objectivesHowever, the parties appearing at the hearing may wish to draw the panel's attention to other parts of the policy.
8. The following parts of the Council's Statement of Licensing Policy appear to be particularly relevant to the application and the relevant representations:
 - 7 General approach to licensing
 - 9.5 Licensing Panel Hearings
 - 18 Need for Licensed Premises
 - 10.3 Conditions that the Licensing Panel may imposeHowever, the parties appearing at the hearing may wish to draw the panel's attention to other parts of the policy.

PROCEDURE

9. The applicant and the makers of the relevant representations have been invited to attend or be represented at the hearing.
10. The panel is asked to use the procedure for the Conduct of Hearings as attached at item 3.

CORPORATE PRIORITIES	
Economy – To create a vibrant and healthy economy	✓
Environment – To deliver services customers expect	✓
Efficiency – By spending money in the most efficient way	✓
Tourism – To create a great place to live and visit	✓

IMPLICATIONS	
Finance	No further implications arising directly from the report
Legal	No further implications arising directly from the report
Community Safety	No further implications arising directly from the report
Human Rights and Equalities	No further implications arising directly from the report
Sustainability and Environmental Impact	No further implications arising directly from the report
Health & Safety and Risk Management	No further implications arising directly from the report

SUMMARY OF PREVIOUS DECISIONS
There are no previous decisions relating to this matter

BACKGROUND PAPERS REVELANT TO THIS ITEM		
Name of document	Date	Where available for inspection
S182 Statement of licensing policy	December 2022	Revised Guidance issued under section 182 of the Licensing Act 2003 (publishing.service.gov.uk)
Fylde Council Statement of Licensing Policy	January 2016	https://new.fylde.gov.uk/wp-content/uploads/2019/05/Final-Statement-of-Licensing-Policy-2016-2021.pdf

LEAD AUTHOR	CONTACT DETAILS	DATE
Joanne Gallagher	Joanne.gallagher@fylde.gov.uk 01253 658609	27 th September 2023

Attached documents

- Appendix 1 - Application form
- Appendix 2 - Plan of premises
- Appendix 3 - Representations
- Appendix 4 – Location Plan



Application for a premises licence to be granted under the Licensing Act 2003

PLEASE READ THE FOLLOWING INSTRUCTIONS FIRST

Before completing this form please read the guidance notes at the end of the form. If you are completing this form by hand please write legibly in block capitals. In all cases ensure that your answers are inside the boxes and written in black ink. Use additional sheets if necessary.

You may wish to keep a copy of the completed form for your records.

I/We Craft and Common LTD

(Insert name(s) of applicant)

apply for a premises licence under section 17 of the Licensing Act 2003 for the premises described in Part 1 below (the premises) and I/we are making this application to you as the relevant licensing authority in accordance with section 12 of the Licensing Act 2003

Part 1 – Premises details

Postal address of premises or, if none, ordnance survey map reference or description 45 Woodlands Road			
Post town	Ansdeil	Postcode	FY8 1DA

Telephone number at premises (if any)	N/A
Non-domestic rateable value of premises	£0

Part 2 - Applicant details

Please state whether you are applying for a premises licence as **Please tick as appropriate**

- a) an individual or individuals * please complete section (A)
- b) a person other than an individual *
- i as a limited company/limited liability partnership please complete section (B)
- ii as a partnership (other than limited liability) please complete section (B)
- iii as an unincorporated association or please complete section (B)

- iv other (for example a statutory corporation) please complete section (B)
- c) a recognised club please complete section (B)
- d) a charity please complete section (B)
- e) the proprietor of an educational establishment please complete section (B)
- f) a health service body please complete section (B)
- g) a person who is registered under Part 2 of the Care Standards Act 2000 (c14) in respect of an independent hospital in Wales please complete section (B)
- ga) a person who is registered under Chapter 2 of Part 1 of the Health and Social Care Act 2008 (within the meaning of that Part) in an independent hospital in England please complete section (B)
- h) the chief officer of police of a police force in England and Wales please complete section (B)

* If you are applying as a person described in (a) or (b) please confirm (by ticking yes to one box below):

- I am carrying on or proposing to carry on a business which involves the use of the premises for licensable activities; or
- I am making the application pursuant to a
 - statutory function or
 - a function discharged by virtue of Her Majesty's prerogative

(A) INDIVIDUAL APPLICANTS (fill in as applicable)

Mr <input type="checkbox"/>	Mrs <input type="checkbox"/>	Miss <input type="checkbox"/>	Ms <input type="checkbox"/>	Other Title (for example, Rev)	
Surname			First names		
Date of birth		I am 18 years old or over <input type="checkbox"/> Please tick yes			
Nationality					
Current residential address if different from premises address					
Post town				Postcode	
Daytime contact telephone number					
E-mail address (optional)					

Where applicable (if demonstrating a right to work via the Home Office online right to work checking service), the 'share code' provided to the applicant by that service (please see note 15 for information)

SECOND INDIVIDUAL APPLICANT (if applicable)

Mr <input type="checkbox"/>	Mrs <input type="checkbox"/>	Miss <input type="checkbox"/>	Ms <input type="checkbox"/>	Other Title (for example, Rev)	
Surname			First names		
Date of birth		I am 18 years old or over		<input type="checkbox"/>	Please tick yes
Nationality					
Where applicable (if demonstrating a right to work via the Home Office online right to work checking service), the 9-digit 'share code' provided to the applicant by that service: (please see note 15 for information)					
Current residential address if different from premises address					
Post town				Postcode	
Daytime contact telephone number					
E-mail address (optional)					
		Where applicable (if demonstrating a right to work via the Home Office online right to work checking service), the 'share code' provided to the applicant by that service (please see note 15 for information)			

(B) OTHER APPLICANTS

Please provide name and registered address of applicant in full. Where appropriate please give any registered number. In the case of a partnership or other joint venture (other than a body corporate), please give the name and address of each party concerned.

Name Craft and Common LTD
Address 45 Woodlands Road, Ansdell, FY8 1DA

Registered number (where applicable) 14938821
Description of applicant (for example, partnership, company, unincorporated association etc.) Limited company
Telephone number (if any) 07753262620
E-mail address (optional) craftandcommonuk@gmail.com

Part 3 Operating Schedule

When do you want the premises licence to start?

DD	MM	YYYY
01	08	2023

If you wish the licence to be valid only for a limited period, when do you want it to end?

DD	MM	YYYY

Please give a general description of the premises (please read guidance note 1)
 The venue will be a paint-your-own pottery/craft shop with bar. We will offer a range of 'sip and paint' crafting activities including pottery and canvas painting in a fun, relaxing and social environment. The concept is designed to appeal to and cater for all ages, groups and artistic talents.

If 5,000 or more people are expected to attend the premises at any one time, please state the number expected to attend.

What licensable activities do you intend to carry on from the premises?

(please see sections 1 and 14 and Schedules 1 and 2 to the Licensing Act 2003)

Provision of regulated entertainment (please read guidance note 2)	Please tick all that apply
a) plays (if ticking yes, fill in box A)	<input type="checkbox"/>
b) films (if ticking yes, fill in box B)	<input type="checkbox"/>
c) indoor sporting events (if ticking yes, fill in box C)	<input type="checkbox"/>

- d) boxing or wrestling entertainment (if ticking yes, fill in box D)
- e) live music (if ticking yes, fill in box E)
- f) recorded music (if ticking yes, fill in box F)
- g) performances of dance (if ticking yes, fill in box G)
- h) anything of a similar description to that falling within (e), (f) or (g)
(if ticking yes, fill in box H)

Provision of late night refreshment (if ticking yes, fill in box I)

Supply of alcohol (if ticking yes, fill in box J)

In all cases complete boxes K, L and M

A

Plays Standard days and timings (please read guidance note 7)			<u>Will the performance of a play take place indoors or outdoors or both – please tick</u> (please read guidance note 3)	Indoors	<input type="checkbox"/>
Day	Start	Finish		Outdoors	<input type="checkbox"/>
				Both	<input type="checkbox"/>
Mon			<u>Please give further details here</u> (please read guidance note 4)		
Tue					
Wed			<u>State any seasonal variations for performing plays</u> (please read guidance note 5)		
Thur					
Fri			<u>Non standard timings. Where you intend to use the premises for the performance of plays at different times to those listed in the column on the left, please list</u> (please read guidance note 6)		
Sat					
Sun					

B

Films Standard days and timings (please read guidance note 7)			<u>Will the exhibition of films take place indoors or outdoors or both – please tick</u> (please read guidance note 3)	Indoors	<input type="checkbox"/>
				Outdoors	<input type="checkbox"/>
				Both	<input type="checkbox"/>
Day	Start	Finish			
Mon			<u>Please give further details here</u> (please read guidance note 4)		
Tue					
Wed			<u>State any seasonal variations for the exhibition of films</u> (please read guidance note 5)		
Thur					
Fri			<u>Non standard timings. Where you intend to use the premises for the exhibition of films at different times to those listed in the column on the left, please list</u> (please read guidance note 6)		
Sat					
Sun					

C

Indoor sporting events Standard days and timings (please read guidance note 7)			<u>Please give further details</u> (please read guidance note 4)
Day	Start	Finish	
Mon			
Tue			<u>State any seasonal variations for indoor sporting events</u> (please read guidance note 5)
Wed			
Thur			<u>Non standard timings. Where you intend to use the premises for indoor sporting events at different times to those listed in the column on the left, please list</u> (please read guidance note 6)
Fri			
Sat			
Sun			

D

Boxing or wrestling entertainments Standard days and timings (please read guidance note 7)			<u>Will the boxing or wrestling entertainment take place indoors or outdoors or both – please tick</u> (please read guidance note 3)	Indoors	<input type="checkbox"/>
				Outdoors	<input type="checkbox"/>
				Both	<input type="checkbox"/>
Day	Start	Finish			
Mon			<u>Please give further details here</u> (please read guidance note 4)		
Tue					
Wed			<u>State any seasonal variations for boxing or wrestling entertainment</u> (please read guidance note 5)		
Thur					
Fri			<u>Non standard timings. Where you intend to use the premises for boxing or wrestling entertainment at different times to those listed in the column on the left, please list</u> (please read guidance note 6)		
Sat					
Sun					

E

Live music Standard days and timings (please read guidance note 7)			Will the performance of live music take place indoors or outdoors or both – please tick (please read guidance note 3)	Indoors	<input type="checkbox"/>
				Outdoors	<input type="checkbox"/>
				Both	<input type="checkbox"/>
Day	Start	Finish			
Mon			Please give further details here (please read guidance note 4)		
Tue					
Wed			State any seasonal variations for the performance of live music (please read guidance note 5)		
Thur					
Fri			Non standard timings. Where you intend to use the premises for the performance of live music at different times to those listed in the column on the left, please list (please read guidance note 6)		
Sat					
Sun					

F

Recorded music Standard days and timings (please read guidance note 7)			<u>Will the playing of recorded music take place indoors or outdoors or both – please tick</u> (please read guidance note 3)	Indoors	<input type="checkbox"/>			
				Outdoors	<input type="checkbox"/>			
				Both	<input type="checkbox"/>			
Day	Start	Finish	<u>Please give further details here</u> (please read guidance note 4)					
Mon								
Tue								
Wed						<u>State any seasonal variations for the playing of recorded music</u> (please read guidance note 5)		
Thur								
Fri						<u>Non standard timings. Where you intend to use the premises for the playing of recorded music at different times to those listed in the column on the left, please list</u> (please read guidance note 6)		
Sat								
Sun								

G

Performances of dance Standard days and timings (please read guidance note 7)			Will the performance of dance take place <u>indoors or outdoors or both – please tick</u> (please read guidance note 3)	Indoors	<input type="checkbox"/>
Day	Start	Finish		Outdoors	<input type="checkbox"/>
Mon			<u>Please give further details here</u> (please read guidance note 4)		
Tue					
Wed			<u>State any seasonal variations for the performance of dance</u> (please read guidance note 5)		
Thur					
Fri			<u>Non standard timings. Where you intend to use the premises for the performance of dance at different times to those listed in the column on the left, please list</u> (please read guidance note 6)		
Sat					
Sun					

H

<p>Anything of a similar description to that falling within (e), (f) or (g) Standard days and timings (please read guidance note 7)</p>			<p>Please give a description of the type of entertainment you will be providing</p>		
Day	Start	Finish	<p><u>Will this entertainment take place indoors or outdoors or both – please tick</u> (please read guidance note 3)</p>	Indoors	<input type="checkbox"/>
Mon				Outdoors	<input type="checkbox"/>
				Both	<input type="checkbox"/>
Tue			<p><u>Please give further details here</u> (please read guidance note 4)</p>		
Wed					
Thur			<p><u>State any seasonal variations for entertainment of a similar description to that falling within (e), (f) or (g)</u> (please read guidance note 5)</p>		
Fri					
Sat			<p><u>Non standard timings. Where you intend to use the premises for the entertainment of a similar description to that falling within (e), (f) or (g) at different times to those listed in the column on the left, please list</u> (please read guidance note 6)</p>		
Sun					

I

Late night refreshment Standard days and timings (please read guidance note 7)			Will the provision of late night refreshment take place indoors or outdoors or both – please tick (please read guidance note 3)	Indoors	<input type="checkbox"/>
				Outdoors	<input type="checkbox"/>
				Both	<input type="checkbox"/>
Day	Start	Finish			
Mon			<u>Please give further details here</u> (please read guidance note 4)		
Tue					
Wed			<u>State any seasonal variations for the provision of late night refreshment</u> (please read guidance note 5)		
Thur					
Fri			<u>Non standard timings. Where you intend to use the premises for the provision of late night refreshment at different times, to those listed in the column on the left, please list</u> (please read guidance note 6)		
Sat					
Sun					

J

Supply of alcohol Standard days and timings (please read guidance note 7)			Will the supply of alcohol be for consumption – please tick (please read guidance note 8)	On the premises	<input checked="" type="checkbox"/>
				Off the premises	<input type="checkbox"/>
				Both	<input type="checkbox"/>
Day	Start	Finish	State any seasonal variations for the supply of alcohol (please read guidance note 5)		
Mon	10:00	22:00			
Tue	10:00	22:00			
Wed	10:00	22:00			
Thur	10:00	23:00			
Fri	10:00	23:00			
Sat	10:00	23:00			
Sun	10:00	22:00			
			Non standard timings. Where you intend to use the premises for the supply of alcohol at different times to those listed in the column on the left, please list (please read guidance note 6)		

State the name and details of the individual whom you wish to specify on the licence as designated premises supervisor (Please see declaration about the entitlement to work in the checklist at the end of the form):

Name Lauren Rowland	
Date of birth	██████████
Address ██████████	
Postcode	FY8 4RT
Personal licence number (if known) FY PA1523	
Issuing licensing authority (if known) Fylde Borough Council	

K

Please highlight any adult entertainment or services, activities, other entertainment or matters ancillary to the use of the premises that may give rise to concern in respect of children (please read guidance note 9).

L

Hours premises are open to the public Standard days and timings (please read guidance note 7)			State any seasonal variations (please read guidance note 5)
Day	Start	Finish	
Mon	09:00	22:30	
Tue	09:00	22:30	
Wed	09:00	22:30	
Thur	09:00	23:30	
Fri	09:00	23:30	
Sat	09:00	23:30	
Sun	09:00	22:30	
Non standard timings. Where you intend the premises to be open to the public at different times from those listed in the column on the left, please list (please read guidance note 6)			

M

Describe the steps you intend to take to promote the four licensing objectives:

a) General – all four licensing objectives (b, c, d and e) (please read guidance note 10)

- The primary purpose of the premises shall be that of a craft studio where the provision of crafting activities is an important element of the premises' operation. Sufficient furniture and seating shall be provided and set out so it does not become a high volume vertical drinking establishment.
- Food shall be available until 9.30pm.
- Seating shall be provided inside the premises for at least 80% of the total maximum capacity of the premises as determined by a risk assessment.
- The backyard, which sits 2 stories to beneath the shop floor to the rear, will only be accessed and used by customers in the event of a fire, where this is one of our fire exit routes and evacuation points.
- When/if used, the outside area to the front of the shop will be closed by 8pm and furniture moved from outside the premises by 8.30pm.
- A health and safety risk assessment will be carried out every 6 months.
- CCTV will be installed throughout the public areas and will have storage lasting 28 days.
- Staff will be trained in the sale of alcohol and the conditions in this premises licence – a training register will be kept.

b) The prevention of crime and disorder

- An incident log book will be kept at the premises detailing the following; refusals, visits from relevant authorities, any acts of disorder.
- Safe capacity limits
- Signage
- A specified time of 30 mins between last sales and the close of premises.

c) Public safety

- A fire risk assessment will be carried out and a fire evacuation policy will be completed. Staff will be trained every 6 months.
- Safe capacity limits
- Staff trained in and informed of public safety measures.

d) The prevention of public nuisance

- Music will be predominantly background level and doors/windows will be kept closed where practicable.
- Signage asking patrons to leave quietly and respect neighbours
- No bright lights outside the premises.
- Access to public transport time tables (train and bus) to avoid unnecessary gatherings outside of the premises in public areas.

e) The protection of children from harm

- A strict challenge 25 policy will be implemented and staff will be trained and tested on this.

Checklist:

Please tick to indicate agreement

- I have made or enclosed payment of the fee.
- I have enclosed the plan of the premises.
- I have sent copies of this application and the plan to responsible authorities and others where applicable.
- I have enclosed the consent form completed by the individual I wish to be designated premises supervisor, if applicable.
- I understand that I must now advertise my application.
- I understand that if I do not comply with the above requirements my application will be rejected.
- [Applicable to all individual applicants, including those in a partnership which is not a limited liability partnership, but not companies or limited liability partnerships] I have included documents demonstrating my entitlement to work in the United Kingdom or my share code issued by the Home Office online right to work checking service (please read note 15).

IT IS AN OFFENCE, UNDER SECTION 158 OF THE LICENSING ACT 2003, TO MAKE A FALSE STATEMENT IN OR IN CONNECTION WITH THIS APPLICATION. THOSE WHO MAKE A FALSE STATEMENT MAY BE LIABLE ON SUMMARY CONVICTION TO A FINE OF ANY AMOUNT.

IT IS AN OFFENCE UNDER SECTION 24B OF THE IMMIGRATION ACT 1971 FOR A PERSON TO WORK WHEN THEY KNOW, OR HAVE REASONABLE CAUSE TO BELIEVE, THAT THEY ARE DISQUALIFIED FROM DOING SO BY REASON OF THEIR IMMIGRATION STATUS. THOSE WHO EMPLOY AN ADULT WITHOUT LEAVE OR WHO IS SUBJECT TO CONDITIONS AS TO EMPLOYMENT WILL BE LIABLE TO A CIVIL PENALTY UNDER SECTION 15 OF THE IMMIGRATION, ASYLUM AND NATIONALITY ACT 2006 AND PURSUANT TO SECTION 21 OF THE SAME ACT, WILL BE COMMITTING AN OFFENCE WHERE THEY DO SO IN THE KNOWLEDGE, OR WITH REASONABLE CAUSE TO BELIEVE, THAT THE EMPLOYEE IS DISQUALIFIED.

Part 4 – Signatures (please read guidance note 11)



Signature of applicant or applicant’s solicitor or other duly authorised agent (see guidance note 12). If signing on behalf of the applicant, please state in what capacity.

Declaration	• [Applicable to individual applicants only, including those in a partnership which is not a limited liability partnership] I understand I
--------------------	--

	<p>am not entitled to be issued with a licence if I do not have the entitlement to live and work in the UK (or if I am subject to a condition preventing me from doing work relating to the carrying on of a licensable activity) and that my licence will become invalid if I cease to be entitled to live and work in the UK (please read guidance note 15).</p> <ul style="list-style-type: none"> The DPS named in this application form is entitled to work in the UK (and is not subject to conditions preventing him or her from doing work relating to a licensable activity) and I have seen a copy of his or her proof of entitlement to work, or have conducted an online right to work check using the Home Office online right to work checking service which confirmed their right to work (please see note 15)
Signature	<i>La Rowland</i>
Date	21/06/2023
Capacity	Applicant

For joint applications, signature of 2nd applicant or 2nd applicant's solicitor or other authorised agent (please read guidance note 13). If signing on behalf of the applicant, please state in what capacity.

Signature	
Date	
Capacity	

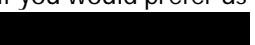
<p>Contact name (where not previously given) and postal address for correspondence associated with this application (please read guidance note 14)</p> <p>Lauren Rowland </p>			
Post town	Lytham	Postcode	FY8 4RT
Telephone number (if any)			
<p>If you would prefer us to correspond with you by e-mail, your e-mail address (optional)</p> <p></p>			

Notes for Guidance

1. Describe the premises, for example the type of premises, its general situation and layout and any other information which could be relevant to the licensing objectives. Where your application includes off-supplies of alcohol and you intend to provide a place for consumption of these off-supplies, you must include a description of where the place will be and its proximity to the premises.
2. In terms of specific regulated entertainments please note that:
 - Plays: no licence is required for performances between 08:00 and 23.00 on any day, provided that the audience does not exceed 500.
 - Films: no licence is required for 'not-for-profit' film exhibition held in community premises between 08.00 and 23.00 on any day provided that the audience does not exceed 500 and the organiser (a) gets consent to the screening from a person who is responsible for the premises; and (b) ensures that each such screening abides by age classification ratings.
 - Indoor sporting events: no licence is required for performances between 08.00 and 23.00 on any day, provided that the audience does not exceed 1000.
 - Boxing or Wrestling Entertainment: no licence is required for a contest, exhibition or display of Greco-Roman wrestling, or freestyle wrestling between 08.00 and 23.00 on any day, provided that the audience does not exceed 1000. Combined fighting sports – defined as a contest, exhibition or display which combines boxing or wrestling with one or more martial arts – are licensable as a boxing or wrestling entertainment rather than an indoor sporting event.
 - Live music: no licence permission is required for:
 - a performance of unamplified live music between 08.00 and 23.00 on any day, on any premises.
 - a performance of amplified live music between 08.00 and 23.00 on any day on premises authorised to sell alcohol for consumption on those premises, provided that the audience does not exceed 500.
 - a performance of amplified live music between 08.00 and 23.00 on any day, in a workplace that is not licensed to sell alcohol on those premises, provided that the audience does not exceed 500.
 - a performance of amplified live music between 08.00 and 23.00 on any day, in a church hall, village hall, community hall, or other similar community premises, that is not licensed by a premises licence to sell alcohol, provided that (a) the audience does not exceed 500, and (b) the organiser gets consent for the performance from a person who is responsible for the premises.
 - a performance of amplified live music between 08.00 and 23.00 on any day, at the non-residential premises of (i) a local authority, or (ii) a school, or (iii) a hospital, provided that (a) the audience does not exceed 500, and (b) the organiser gets consent for the performance on the relevant premises from: (i) the local authority concerned, or (ii) the school or (iii) the health care provider for the hospital.
 - Recorded Music: no licence permission is required for:
 - any playing of recorded music between 08.00 and 23.00 on any day on premises authorised to sell alcohol for consumption on those premises, provided that the audience does not exceed 500.
 - any playing of recorded music between 08.00 and 23.00 on any day, in a church hall, village hall, community hall, or other similar community

- premises, that is not licensed by a premises licence to sell alcohol, provided that (a) the audience does not exceed 500, and (b) the organiser gets consent for the performance from a person who is responsible for the premises.
- any playing of recorded music between 08.00 and 23.00 on any day, at the non-residential premises of (i) a local authority, or (ii) a school, or (iii) a hospital, provided that (a) the audience does not exceed 500, and (b) the organiser gets consent for the performance on the relevant premises from: (i) the local authority concerned, or (ii) the school proprietor or (iii) the health care provider for the hospital.
- Dance: no licence is required for performances between 08.00 and 23.00 on any day, provided that the audience does not exceed 500. However, a performance which amounts to adult entertainment remains licensable.
 - Cross activity exemptions: no licence is required between 08.00 and 23.00 on any day, with no limit on audience size for:
 - any entertainment taking place on the premises of the local authority where the entertainment is provided by or on behalf of the local authority;
 - any entertainment taking place on the hospital premises of the health care provider where the entertainment is provided by or on behalf of the health care provider;
 - any entertainment taking place on the premises of the school where the entertainment is provided by or on behalf of the school proprietor; and
 - any entertainment (excluding films and a boxing or wrestling entertainment) taking place at a travelling circus, provided that (a) it takes place within a moveable structure that accommodates the audience, and (b) that the travelling circus has not been located on the same site for more than 28 consecutive days.
3. Where taking place in a building or other structure please tick as appropriate (indoors may include a tent).
 4. For example the type of activity to be authorised, if not already stated, and give relevant further details, for example (but not exclusively) whether or not music will be amplified or unamplified.
 5. For example (but not exclusively), where the activity will occur on additional days during the summer months.
 6. For example (but not exclusively), where you wish the activity to go on longer on a particular day e.g. Christmas Eve.
 7. Please give timings in 24 hour clock (e.g. 16.00) and only give details for the days of the week when you intend the premises to be used for the activity.
 8. If you wish people to be able to consume alcohol on the premises, please tick 'on the premises'. If you wish people to be able to purchase alcohol to consume away from the premises, please tick 'off the premises'. If you wish people to be able to do both, please tick 'both'.
 9. Please give information about anything intended to occur at the premises or ancillary to the use of the premises which may give rise to concern in respect of children, regardless of whether you intend children to have access to the premises, for example (but not exclusively) nudity or semi-nudity, films for restricted age groups or the presence of gaming machines.
 10. Please list here steps you will take to promote all four licensing objectives together.
 11. The application form must be signed.
 12. An applicant's agent (for example solicitor) may sign the form on their behalf provided that they have actual authority to do so.

13. Where there is more than one applicant, each of the applicants or their respective agent must sign the application form.
14. This is the address which we shall use to correspond with you about this application.
15. Entitlement to work/immigration status for individual applicants and applications from partnerships which are not limited liability partnerships.

A licence may not be issued to an individual or an individual in a partnership which is not a limited liability partnership who is resident in the UK who:

- does not have the right to live and work in the UK; or
- is subject to a condition preventing him or her from doing work relating to the carrying on of a licensable activity.

Any licence issued in respect of an application made on or after 6 April 2017 will become invalid if the holder ceases to be entitled to work in the UK.

Applicants must demonstrate that they have the right to work in the UK and are not subject to a condition preventing them from doing work relating to the carrying on of a licensing activity.

They do this in one of two ways:

- 1) by providing with this application copies or scanned copies of documents which an applicant has provided, to demonstrate their entitlement to work in the UK (which do not need to be certified) as per information published on GOV.UK and in guidance.
- 2) by providing their 'share code' to enable the licensing authority to carry out a check using the Home Office online right to work checking service (see below).

Home Office online right to work checking service

As an alternative to providing a copy of the original documents, applicants may demonstrate their right to work by allowing the licensing authority to carry out a check with the Home Office online right to work checking service.

To demonstrate their right to work via the Home Office online right to work checking service, applicants should include in this application their 9 share code (provided to them upon accessing the service at <https://www.gov.uk/prove-right-to-work>) which, along with the applicant's date of birth (provided within this application), will allow the licensing authority to carry out the check.

In order to establish the applicant's right to work, the check will need to indicate that the applicant is allowed to work in the United Kingdom and is not subject to a condition preventing them from doing work relating to the carrying on of a licensable activity.

An online check will not be possible in all circumstances because not all applicants will have an immigration status that can be shared digitally. The Home Office online right to work checking service sets out what information and/or documentation applicants will need in order to access the service. Applicants who are unable to obtain a share code from the service should submit copies of documents as set out above.

Your right to work will be checked as part of your licensing application and this could involve us checking your immigration status with the Home Office. We may otherwise share information with the Home Office. Your licence application will not be determined until you have complied with this guidance.

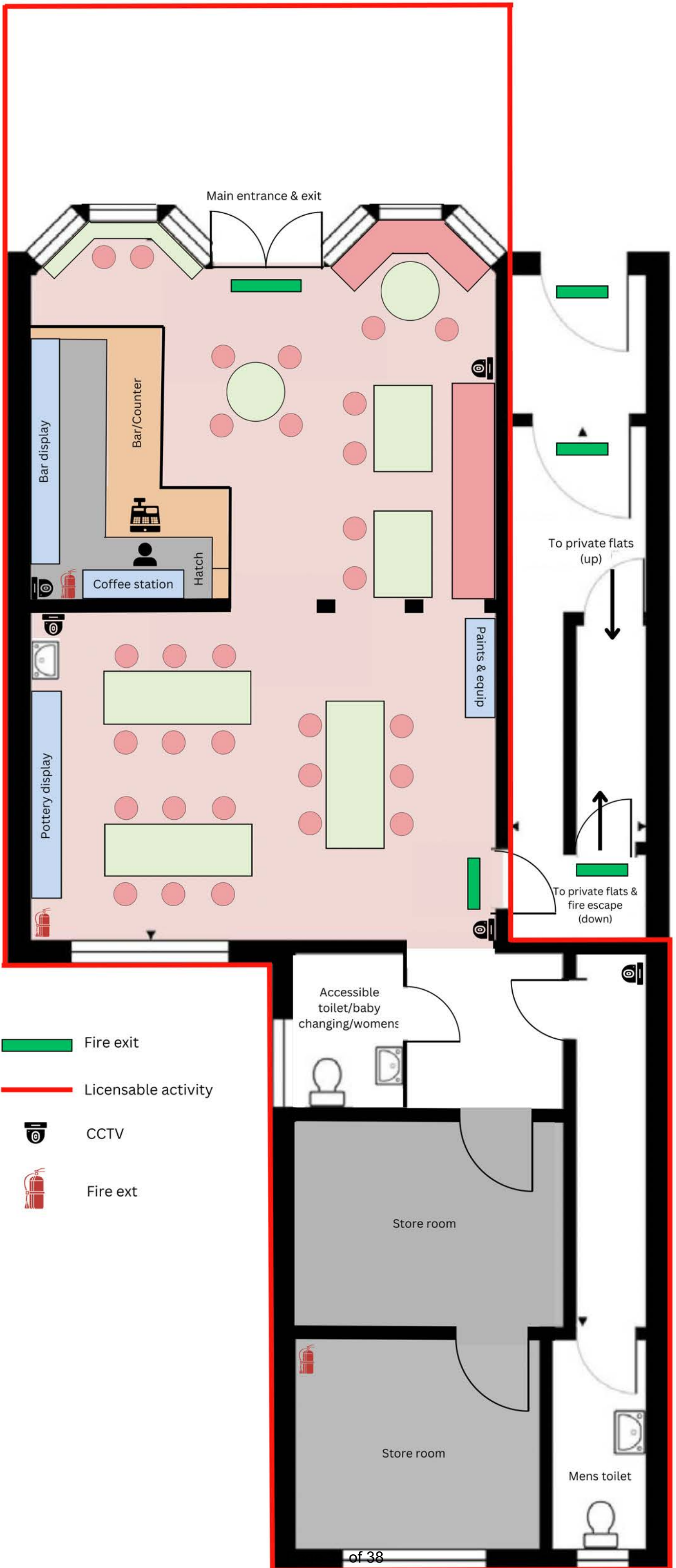

From: [Electronic Forms](#)
 To: [Licensing](#)
 Subject: Licensing Act 2003 Representation
 Date: 17 September 2023 18:09:01

A Licensing Act 2003 Representation has been submitted.

Customer details

In what capacity are you making this representation **A person**

Name

[REDACTED] **St Annes FY81AE**

Phone number

Email address

Premises details

Name of premises/club **Craft and Common**

Address of premises **45 Woodlands Rd Ansdell**

Reference number

Which of the Licensing Objectives does your representation refer to? **The prevention of public nuisance, The prevention of crime & disorder, The protection of children from harm**

What are your concerns? **I have lived in Lytham St Annes for. 76 years, 2 in St Annes 15 in Lytham and 59 in Ansdell. I think I know Ansdell as well as anyone. I'm on holiday but feel so concerned about this application, a concern shared by my neighbours, that I must make this representation again. I note that the applicants do not have to resubmit their business plan (BP) but I have to submit a new representation, despite being told that the applicants have yet again changed their application. Clearly it is in their interest to do so, but how can these be genuine when they have not changed their (BP). They are still able to have "girly nights" otherwise known as "hen parties" and to avoid discrimination, presumably boys nights known as stag nights ? From my personal experience as a licensing magistrate over several years I know how these applications can appear reasonable but can easily be manipulated over time. The (BP) is little more than a blueprint for a drinking establishment in the middle of a quiet residential area. There are even questions to be asked as to how the (BP) is supported by the physical plan. They say in the BP they will provide meals, but there is no kitchen, not enough seats for the 32 covers, and no extractor fan (thank goodness for the latter). It would appear that there would be standing and drinking at the bar, perhaps with children present 1) Prevention of Crime and Disorder I do not feel that this is an honest application for a " Craft " establishment, but rather an application for a drinking establishment. The applicants appear to have little knowledge of such applications perhaps indicated by their need to apply a second time. There is little active policing, and a current burglary issue, which they seem to have difficulty in preventing. Neighbours of mine are talking about needing to move elsewhere. A late night drinking establishment is not required, we have well established pubs at the Fairhaven and Blossoms, and craft classes could easily be accommodated at the Ansdell Institute. 2) Prevention of Public Nuisance There can be little of more nuisance to local residents than the noise and nuisance caused by people leaving licensed premises late at night. Both pubs mentioned are well established and well managed as is Ansdell Institute, all are a considerable distance from their neighbours. 45 Woodlands Rd is a terraced property with 8 apartments attached to it. More across the road at the corner of Woodlands Rd and Windsor Rd, a residential facility at the corner of Woodlands Rd and Kingsway and yet another Seabourne Crescent a block of flats ALL within a few yards of 45**

Woodlands Rd. Whilst an assurance has been given that there will be no immediate use of the area fronting No 45, if granted can we be surprised to see alcohol being drunk on what we currently regard as a pavement? 3)Protection of Children from Harm There are very young children living inside the property and it is neighbours living within a close proximity that are expressing the most concern. You may feel that more should have made representation, but there are several reasons why they haven't. Not least, not knowing what is proposed, as unlike planning applications neighbours are not notified, local papers are not bought as often as in the past, particularly by cash strapped families, and other reasons of which I'm aware our local councillors have been informed. The extent to which young children will be exposed to drinking, and until what time is not clear to me from their business plan. Finally, you must decide whether or not you take a risk, and allow the application despite the issues I have raised in line with 3 of the 4 Objectives required within the Act, and hope problems and upset to the young and old do not materialise, or do you support your constituents in our concerns and our strongly held opinion that this application should be rejected Regards. [REDACTED]

Suggested amendments I see nothing but problems if this application is granted. I have received no response to my request to see the risk assessment reports if any from the police, fire service etc. although my previous and this representation will be shown to the applicants. If the application is granted we will expect to see restrictions being applied that you feel will appropriately address the concerns we have raised.

This account isn't monitored, please do not reply

I am a tenant at [REDACTED] Woodlands Road, Lytham St Annes, FY81DA and wish to raise an objection to the licensing application regarding Craft and Common LTD, 45 Woodlands Road, FY81DA which I believe would be detrimental to the area.

As a quick overview, Woodlands Road is divided into 2 distinct areas by the railway bridge, the area in discussion being the most residential, with just a few 9-5 Monday to Saturday businesses bar a takeaway which operates 7 days per week, it is very quiet in the evening with little footfall bar local residents, local families and dog walkers heading to the beach, there are a number of residential flats above the businesses and directly opposite the proposed Craft & Common is Windsor Lodge which is a large retirement flat complex housing elderly people.

The selling of alcohol in this area would encourage a drinking culture which invariably makes its ways out into the local streets.

An Alcohol licence will draw unwelcome attention and increased footfall at unsociable hours to this normally quiet residential area comprising of residential flats above the businesses and old people's homes, indeed directly opposite the proposed business Craft and Common LTD only metres away is Windsor Lodge (as mentioned above), also nearby is a sheltered housing complex and 2 funeral homes.

Furthermore the selling of alcohol does not sit well from a child protection point of view, the establishment states it provides crafts for all ages, alcohol and children do certainly not go hand in hand.

I believe noise, public nuisance, anti-social behaviour, low-level nuisance (non-reportable crime inc. shouting, littering) will be increased; evening opening times in a normally quiet residential area will unnecessarily draw people from a wider area at unsociable hours. Signage will also be visible from a distance which will add to additional draw of pedestrians and vehicles.

Noting again this is a quiet residential area and I believe noise, light pollution, traffic and traffic noise will have a negative impact on this area. Additional traffic to an already busy road in the daytime could have serious public safety implications.

I believe the proposed business Craft and Common LTD will attract considerably more traffic than the area can handle, leading to congestion on the immediate main road as well as in the surrounding residential roads which are already full every day, this would have a detrimental effect to existing businesses in daytime hours.

The application states capacity will be 37 seated plus 11 standing taking the total to 48, with staff this will most likely rise to over 50 people potentially creating a very busy venue. This will also likely mean groups outside smoking / talking etc. I believe this is a real concern, this will cause overshadowing to the main residential entrance to 47 Woodlands Rd (8 residential homes) plus the residential entrance to a number of flats at 45 Woodlands Rd.

In light of the above objections I raise, I strongly believe this application requires re-reviewing and resubmitting; also I believe the application is unclear and the following 3 points require clarification.

1. Has a pavement licence now been applied for as the new application and plans still show the area of licensable activity (marked in red) extends outside? The available outside space is very small, indeed the perimeter of the outdoor space towards the road has a very large fixed planter on one corner and a tree on the opposite restricting space even further and the outside space is extremely close to the residential entrances to number 45 and 47 Woodlands Rd. No intended seating outside has been shown on the plans and will this increase capacity? Also are there any plan to store kegs outside the front of the business? These would be an obstruction and absolute eyesore.
2. The application states food will be served until 9.30pm but the plans show no kitchen nor ventilation for such?
3. The submitted plans do not clearly indicate the layout of the building, being one of the highest points in the area although the proposed entrance to Craft and Common LTD is on the ground floor on Woodlands Road, the back entrance which I assume will also be emergency exit is two floors lower due to the building being on a hill, the dining/craft area, store room and gents toilet will therefore directly overlook the back yard of 49 Woodlands Road and neighbouring properties on Woodlands Road plus the back street and rear of the properties on Princes Road.

Furthermore, I can only assume that the commercial rubbish (including cans and bottles which will be very noisy when disposed of), and kegs from the business will be stored amongst the existing tenants' rubbish at 49 Woodlands Road, potentially causing a health and safety issue and furthermore will cause extra noise at unsocial hours causing widespread disturbance in the neighbourhood. Extra traffic of deliveries/removal of commercial waste will make it difficult for residents to negotiate access to their properties and garages.

Thank you for taking the time to consider these objections, I hope they will be seriously considered. I understand that the Mayor and local councillor are also in support of objections from residents.

Yours sincerely

[REDACTED]

[REDACTED]

[REDACTED]

FY81DA

Date: 18 / 9 / 23

From: [REDACTED]
To: [Licensing](#)
Subject: FW: Licensing application 45 Woodlands Rd Ansdell FY81AD
Date: 19 September 2023 13:04:30

External Email - Use Caution

Sent from my Galaxy

----- Original message -----

From: [REDACTED]
Date: 19/09/2023 (GMT+00:00)
To: licensing@fylde.gov.uk
Subject: Licensing application 45 Woodlands Rd Ansdell FY81AD

To whom it may concern

I need to make an objection to the licensing application for premises 45 Woodlands Rd Ansdell. My objection is based on prevention of public nuisance.

The council may or may not be aware that residents of Ansdell have endured persistent antisocial behaviour which has escalated over many months! I am aware that this is a problem that the mayor and the police (in particular PCSO Trevor Sterling) have promised to prioritise.

Many elderly residents live very close to 45 Woodlands Rd! Parents with children are trying to maintain a healthy sleeping regime for schooling!

Several residents of Kingsway Princes Rd and Commonsides came together very recently to support each other to put a stop to antisocial behaviour in Ansdell. Our recent efforts to facilitate a more peaceful and harmonious environment will be undermined at a time when the police have been given significant funding to tackle antisocial behaviour.

I put it to the Borough of Fylde licensing authority that granting a licence to 45 Woodlands Rd will result in increased noise, general disturbance, litter and antisocial behaviour which is not acceptable to the elderly, young and the residents who are close to the above premises.

[REDACTED]
Ansdell
FY81AB

Sent from my Galaxy

This email has been scanned for spam & viruses. If you believe this email should have been stopped by our filters, [click here](#) to report it.

45 Woodlands Road

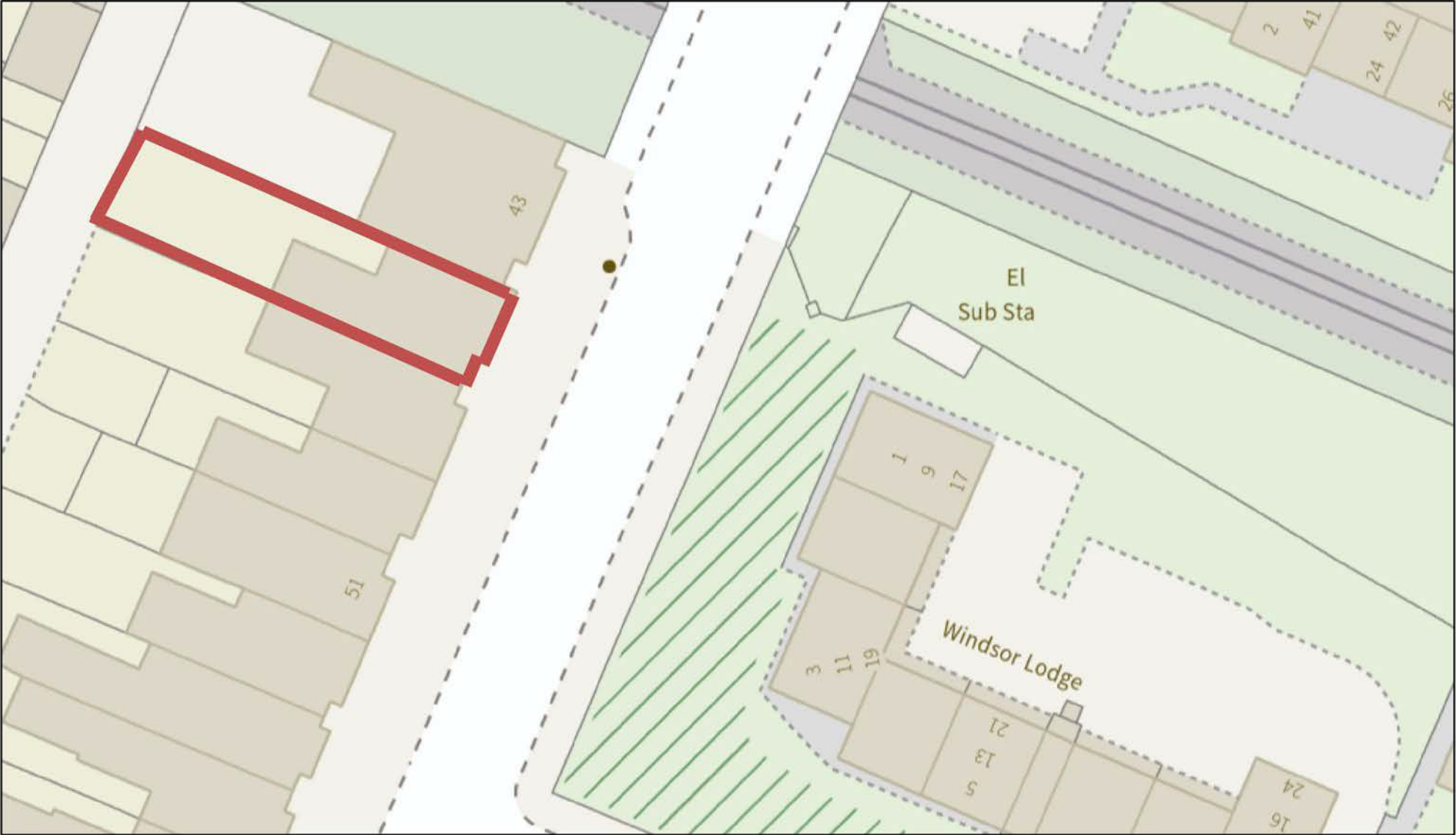

8/1/2023, 1:10:12 PM

