

Community Outlook Forum



Date	6 February 2006
Venue	Council Offices, Derby Road, Wesham
Committee members	Louis Rigby (Chairman) Susan Fazackerley (Vice-Chairman) Richard Fulford-Brown, Heather Speak, William Thompson, Colin Walton
Other Councillors	Tim Ashton, Harold Butler, Raymond Norsworthy, Dawn Prestwich, John Prestwich, Paul Rigby.
Officers	Peter Welsh, Carolyn Whewell
Others	Alan Cavill and Antony Lockley (Blackpool Borough Council). Cath Powell, Mary Wilson and Anne Aitken (Park View 4 U).

1. Declarations of interest

Members were reminded that any personal/prejudicial interests should be declared as required by the Council's Code of Conduct adopted in accordance with the Local Government Act 2000.

2. Confirmation of minutes

RESOLVED: To approve the minutes of the Community Outlook Forum meeting held on 17 October 2005 as a correct record for signature by the chairman.

3. Substitute members

The following substitutions were reported under council procedure rule 22.3:

Councillor Heather Speak for councillor Mrs Henshaw.

4. The Northern Way

Members were informed that Blackpool Council was co-ordinating the Northern Way programme of work for the Fylde Coast concentrating on two of the main priorities: advance manufacturing and tourism, both of which had major implications for Fylde.

Alan Cavill and Antony Lockley from Blackpool Borough Council made a presentation on the background, progress to date and future developments on the Northern Way Programme. (Details of the presentation are appended).

Following the presentation a questions and answers session was held during which Members raised a number of issues, which included:- how the programme could assist industries in the area; improvements to Blackpool airport and the impact on residents in the surrounding areas; expansion of the tramway system.

Members also expressed concern about the lack of information and public awareness of the Northern Way project. Members sought assurances that they would be kept informed and involved during any future rounds of consultation.

Following the presentation and questions and answers session the Forum RESOLVED to note the information provided and requested that the Council be kept fully informed of future developments.

5. Park View 4U

Cath Powell, Mary Wilson and Anne Aitken from Park View 4 U presented the latest developments from the Park View 4 U campaign.

Two years ago, local parents formed a community group to try and provide 'swings for the kids' on Park View playing fields, in Lytham. Their plans soon expanded when they realised the enthusiasm of the local children. Park View 4 U was now a registered charity (number 1107916) and worked closely with Fylde Borough Council, as well as many other local and national organisations and government bodies. All of the work done was voluntary and all money donated went towards improving the park. Several fundraising events had been held to cover expenses such as the printing and distribution of leaflets.

Park View 4 U were over half way to raising the money for what was now a one million pound development that would provide play, sporting and recreational facilities for all members of the local community, regardless of age or ability. They had already installed two teenage shelters, two cycle paths providing safe routes to local schools, and a multi-use games area. They had worked closely with FBC to get a new drainage system installed, and negotiated joint use of Aegon's adjoining car park.

Most of the work so far had gone into ensuring the park was in keeping with its natural surroundings, along with related issues such as traffic calming measures. A new entrance feature was due to be installed in early February.

The ongoing drainage of the football pitches was fully funded and there should be at least two of the four pitches ready for use by the end of this year.

The plans and artist's impressions for the park had now been released and specialists were designing the individual areas of the park (skate park, BMX track etc.) with input from the children who would be using them.

Following the presentation the Forum RESOLVED to congratulate and thank Park View 4 U for all their work over the last two years

6. Review of outside bodies - annual report

Carolyn Whewell (Overview and Scrutiny Officer) reported details from the findings of the annual reports on outside bodies submitted by Member representatives and outside bodies.

There were a total of sixty-one outside bodies on the list with one hundred and two seats

Community Outlook Forum - 6 February 2006

on them. Members of the Council were asked to determine appointments for seats in the Full Council meeting on 26th May 2005.

The main objective of the review was to assess the value of member representation on outside bodies based on the following points:

- To define defunct partnerships and whether continued representation on these bodies is necessary.
- To assess the benefits to the Council and the body of member representation.
- To determine whether the Council should continue to be represented on each outside body.
- To amend the Council records accordingly.

The Community Outlook Forum agreed in September 2005 that the Annual report would be submitted in the form of a questionnaire that members completed for each body on which they sat. A corresponding questionnaire was sent out to each outside body to supplement the information from members.

The main body of the report detailed the main findings from each of the outside bodies.

Approximately 87% responses were received from members and 45% from outside bodies. The consultation period with a deadline of the 15th December was extended following a reminder letter sent out to all non-respondents.

The results showed that a number of outside bodies had now been disbanded therefore it had been recommended that these bodies be removed from the Council's official records of Outside Bodies. Where applicable, changes to outside bodies had been noted and recommendations made for amendments to the records shown.

Currently, Full Council approved all appointments to outside bodies on an annual basis. Following the process of this review, it would be advisable that all future requests for Councillor representation are put to the Community Outlook Forum for approval prior to being endorsed by Full Council. This provided the Forum with the opportunity to assess the value of membership to outside bodies on an individual basis.

Following consideration the Forum RESOLVED:-

1. To approve that all future requests for Councillor representation come before the Community Outlook Forum for evaluation.
2. To implement the summary of recommendations (appended).
3. That appointments to outside bodies should be based on the Members knowledge and interest of the organisation and that there be an expectation for all members representing the Council to attend all meetings of the outside body to which they have been appointed.
4. To thank Councillors for submitting their annual reports to the Community Outlook Forum.

Northern Way and Masterplan: Progress and Next Steps

Antony Lockley & Alan Cavill, Blackpool Council



Northern Way: Context

- Central Lancashire CRDP published June 2005
- CRDP well received; detailed feedback provided
- Partners resolved to improve CRDP in preparation for CSR07 and further sub-regional working
- Second iteration required by September 2006

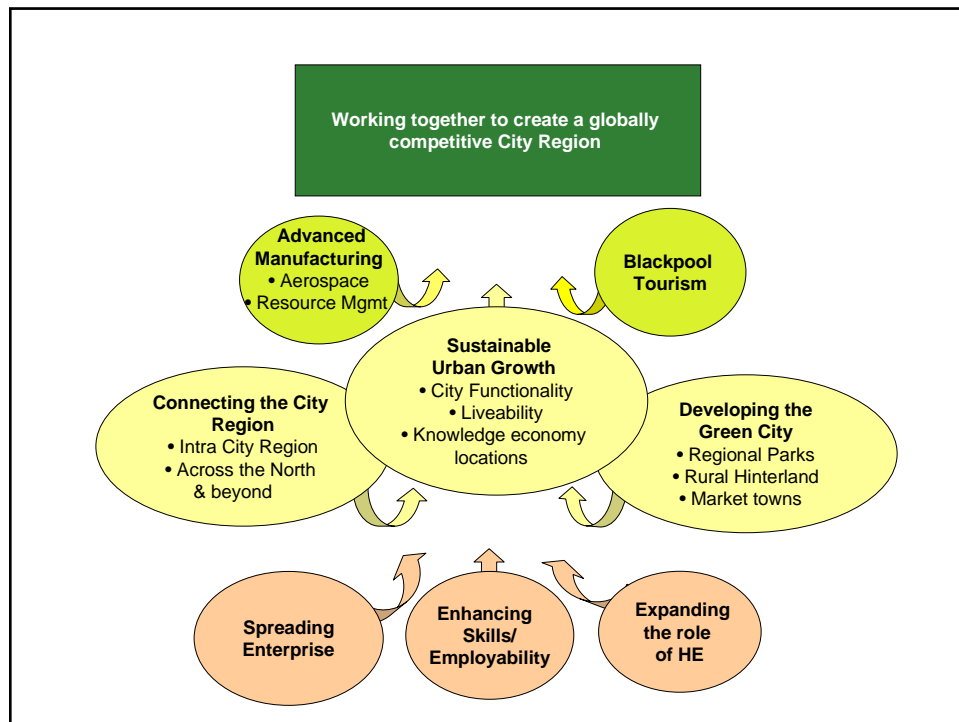

Northern Way: Progress

- Creation of city region economic forecasts and scenarios
- Working groups established to improve, refine and integrate content on each of the priorities
- Aim: improved and more sophisticated second iteration, to dovetail with RES

Northern Way: Next Steps

- Evidence to be compiled before summer
- First draft ready in June, followed by consultation period
- Submission in September, ready for Comprehensive Spending Review

Second Iteration: Early Thinking

- Priorities to be expressed in terms of ***projects*** and ***enablers***
- Northern and Regional ***Projects***: Advanced Manufacturing, New Blackpool, Preston City Vision, East Lancashire Transformational Agenda
- ***Enablers***: Connectivity, Strategic Sites, Housing, Skills, HE/FE, Worklessness, Enterprise, Green City

The Big Picture

- Northern Way is a tool for the North to pressure government during CSR07
- Longevity of initiative uncertain
- City region status has been of real value to area – RES, RSS – far better deal than we would have obtained otherwise
- Keep playing the game

Our Vision



A town looking in 2 directions;
at the values and needs of the
visitor and local resident.



A resort that has been reshaped physically
and spiritually and represented as;

- a new national/international sustainable,
..year round entertainment destination
- a place with balanced and healthy
..neighbourhoods, that is also the retail,
..business, civic and cultural centre for the
..Fylde coast sub-region.

The Regeneration Focus and the URC

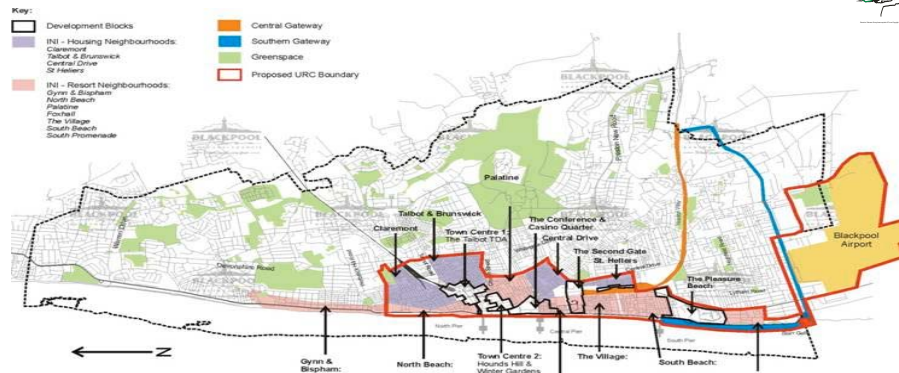

- National** – Urban White Papers, Planning and Compensation Act 2004, Sustainable Communities Plan, Tomorrow's Tourism and Towards Quality Coastal Tourism
- Regional** – RES, RPG, New Vision for North West Coastal Resorts, NWDA's Strategy for Tourism in England's North West

Strong Strategic Fit



Beacon Council
Building a Better Community for All



Blackpool Council
Building a Better Community for All

Illustrative Financial Plan

Public Sector Costs and Income

Costs

Resort Regeneration	-	£ 505m
Resort Neighbourhoods	-	£ 48m
Residential Neighbourhoods	-	£ 85m
Strategic Transport	-	£ 109m
Delivery Costs	-	£ 18m
Total Gross Public Cost	-	£ 759m

URC Revenue Cost

Income

Land receipts to public sector	-	£ 145m
Planning gains	-	£ 90m
Ground rents	-	£ 110m
Total net public Cost	-	£ 420m

Total net Investment - £2,596m

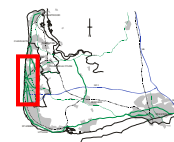

Beacon Council
Building a Better Community for All



Blackpool Council
Building a Better Community for All

Illustrative Financial Plan

Public Sector Funding by Source

Funding Source

NWDA	-	£ 150m
EP	-	£ 55m
BC (including Housing Corporation)	-	£ 84m
DEFRA	-	£ 39m
DfT	-	£ 80m
LCC	-	£ 22m

Total Net Public Cost - £ 420m

Excludes revenue and maintenance costs

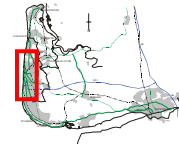

Benefits

Development

Residential	-	1,200 units
Hotel	-	2,280 rooms
Retail Floorspace	-	103,000 sqm
Public Realm	-	340,900 sqm
Transport	-	23,500 sqm
Casino	-	32,500 sqm
Café/bar /A3	-	45,150 sqm
Family Leisure	-	28,000 sqm
Conference/exhibition	-	32,300 sqm
Office/commercial	-	155,000 sqm

Private Sector Investment(outturn prices) £2,176m
Brownfield Development 127 hectares

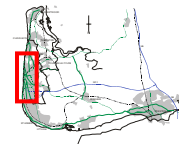

Benefits

Jobs

Total Net (after leakage, displacement, multipliers, deadweight)

Blackpool Travel to Work Area	-	9,195
Lancashire	-	11,045
North West	-	8,500

Wider Impact

Urban renaissance
Regional, International Competitiveness
Strong, sustainable economic base
Social Inclusion
Image Enhancement
Environment
Healthy, balanced communities

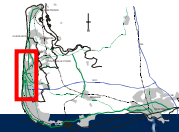

Summary of Recommendations

ORGANISATION	REPRESENTATIVES/ COUNCILLORS	RECOMMENDATION
Access for All	Vacancy Vacancy Vacancy	A Councillor is appointed as soon as possible
Age Concern Fylde	Councillor R.J.Wilson Vacancy	The Community Outlook Forum to address the Councillor representation as part of its quarterly review of Age Concern
Blackpool Airport Consultative Committee	Councillor J.G.Longstaff	The Council continues with representation on this body
Blackpool Grand Theatre Trust	Councillor A. W. Jealous NP Councillor F. Wilson	The Council does not continue with this partnership and removes it from the list of active outside bodies.
Blackpool, Fylde & Wyre Society for the Blind	Councillor J. Prestwich	The Council continues with representation on this body
British Aerospace engineering Systems	Councillor Threlfall	BAE systems to be added to the list of outside bodies and Councillor Threlfall continues to represent the Council
Citizens Advice Bureau (Management Committee) (Kirkham & Fylde)	Councillor P. Hardy Councillor L. Rigby	The Council continues with representation on this body
Citizens Advice Bureau (Management Committee) (Lytham St Annes)	Councillor E. G. Bamber Councillor Mrs B. Pagett	The Council continues with representation on this body
Clifton (Lytham) Housing Association Ltd. Directors)	Councillor P. A. Fieldhouse Councillor L. Rigby Councillor W. Thompson Councillor T. M. Ashton Councillor M. K. Taylor, Councillor H.M. Wilson	The Council continues with representation on this body. Councillor Martin Taylor is removed from the list of representatives
Consortium of Lancashire Aerospace - (CLA)	Executive Brief- Economy	No report received
Council for Voluntary Services, Blackpool, Wyre and Fylde	Councillor A Pounder	The Council continues with representation on this body
District Liaison Committee for Education	Councillor J. A. Dolan Councillor G. Caldwell	The Council continues with representation on

	Councillor K. Hyde Councillor Mrs. H.M. Wilson Councillor B. Pagett	this body
European Economic Community Co-ordinating Committee	Executive brief- Economy	The Council no longer continues with this partnership and removes it from the list of outside bodies.
Face to Face (Homeless Project)	Councillor C Walton	The Council continues with representation on this body
Forum on Health and Well Being for Lancashire	Executive brief- Quality of Life	The Council no longer continues with this partnership and removes it from the list of outside bodies.
Fylde Arts Executive Committee	Councillor Mrs H. M. Wilson Councillor H. Henshaw Vacancy	The Council continues with representation on this body Full Council to nominate another member representative as soon as possible.
Fylde District Youth and Community Advisory Committee	Councillor A.M. Whittaker Councillor S. P. Renwick	No report received.
Fylde Locality Health Improvement Committee	Executive brief- Quality of Life	The Council no longer continues with this partnership and removes it from the list of outside bodies.
Fylde Police & Community Forum	Councillor J. B. Bennett Councillor J. A. Dolan Councillor Mrs D Prestwich Councillor R. S. Small Councillor R.J. Wilson	The Council continues with representation on this body
Kirkham & Rural Fylde Partnership	Councillor S.P. Renwick Councillor E.A. Oades	No recommendation
Kirkham Museum Project Organisation	Councillor S. P. Renwick	No report received.
LCC Health & Equalities Overview & Scrutiny Committee	Councillor R A Fullford-Brown	No recommendation
Lancashire Forum on Poverty and Economic Disadvantaged	Executive brief - Community	The Council no longer continues with this partnership and removes it from the list of outside bodies.
Lancashire Tourism Partnership	Executive brief- Economy	The Council no longer continues with this

		partnership and removes it from the list of outside bodies.
Lancashire Youth and Community Service Advisory- Advice Development Rural Fylde Committees	Councillor A M Whittaker	The Council amend the records to reflect the merger to District Youth and Community Service Liaison Connexions Advisory Committee The Council continues to be represented on this body.
Lancashire Youth and Community Service Advisory Committees - Kirkham Youth Base	Councillor P Hardy	
Lancashire Youth and Community Service Advisory Committees – Rural Fylde Villages Youth Work	Councillor T Threlfall	
Lancaster University, Court of	Councillor G. Caldwell	The Council continues to be represented on this body.
Local Government Association	Leader of the Council	The Council continues to be represented on this body.
Local Government Urban & Rural Commissions	Leader of the Council	The Council continues to be represented on this body.
Local Liaison Committee, Springfield Works	Councillor T. Threlfall	The Council continues to be represented on this body.
Lytham Community Sports Centre	Councillor T. Ashton	The Council no longer continues with this partnership and removes it from the list of active outside bodies
Lytham St Annes Twinning Association	Councillor Mrs H M Wilson Councillor R. Wilson	The Council no longer continues with this partnership and removes it from the list of active outside bodies
Lytham Town Trust	Councillor T. M. Ashton	The Council continues to be represented on this body.
N.W. Lancashire Public Transport Liaison Committee	Executive brief- Economy	The Council no longer continues with this partnership and removes it from the list of active outside bodies
New Fylde Housing	Councillor A G Pounder Councillor S P Renwick Councillor P Rigby Councillor R S Small	The Council continues to be represented on this body.

	Councillor K Wright	
North West Lancashire Community Legal Service Partnership	Leader of the Council	The Council continues to be represented on this body pending further information on the North West Community Legal Service Partnerships.
North West Local Government Association	Leader of the Council	The Council no longer continues with this partnership and removes it from the list of active outside bodies
North West Regional Assembly	Councillor J L Coombes Councillor P.J. Hayhurst Councillor R. Small	The Council no longer continues with this partnership and removes it from the list of active outside bodies
North West Sport Assembly	Executive brief - Community	The Council no longer continues with this partnership and removes it from the list of active outside bodies
North West Tourist Board	Executive brief- Economy	No report received
North Western Local Authorities Employers Organisation	Chairman Licensing & Appeals Committee	The Council continues to be represented on this body
Ribble Discovery Centre	Councillor Martin Taylor	This body is added to the Council's records Councillor Martin Taylor continues to represent the Council.
Ribble Estuary Advisory Group	Leader of the Council Executive brief - Economy, Executive brief - Environment Executive brief - Quality of Life	The Council continues to be represented on this body
Road Safety Forum	Executive brief-Economy	The Council no longer continues with this partnership and removes it from the list of active outside bodies
Social Services Day Centre Committee (Park View House Lytham)	Councillor S. P. Renwick. 1 vacancy	No report received
Social Services Day Centre Committee (Sunnybank Day Centre)	Councillor S. P. Renwick	No report received
St Annes on Sea Development Partnership	Executive Brief - Economy	No report received
Valuation & Community	Councillor J. G. Longstaff	The Council continue to

Charge Tribunals	Councillor C Walton Councillor H Butler Councillor A. G. Pounder	be represented on this body
Waste Management Steering Group	Executive Brief - Economy	The record are amended to reflect the change in name to "Lancashire Waste Partnership The Council continues to be represented on this body
West Coast Rail 250 Campaign	Councillor G. Caldwell	The Council continues to be represented on this body