



# Agenda

## Licensing Hearing

Date:	Thursday 7 December 2017 – 2:30pm
Venue:	Town Hall, St Annes, FY8 1LW
Committee members:	Councillor Peter Hardy (Convenor) Councillor Brenda Blackshaw Councillor Ray Thomas Councillor Jan Barker (Reserve)

Item		PAGE
1	<b>Declarations of Interest:</b> Declarations of interest, and the responsibility for declaring the same, are matters for elected members. Members are able to obtain advice, in writing, in advance of meetings. This should only be sought via the Council's Monitoring Officer. However, it should be noted that no advice on interests sought less than one working day prior to any meeting will be provided.	1
2	<b>Procedure for the Conduct of Hearings</b>	3 - 4
3	<b>Application For The Grant Of A Premises Licence – Morrisons Daily Filling Station, Squires Gate Lane, Blackpool</b>	5 - 27

Contact: Sharon Wadsworth - Telephone: (01253) 658546 – Email: [democracy@fylde.gov.uk](mailto:democracy@fylde.gov.uk)

The code of conduct for members can be found in the council's constitution at  
<http://fylde.cmis.uk.com/fylde/DocumentsandInformation/PublicDocumentsandInformation.aspx>

**© Fylde Borough Council copyright 2017**

You may re-use this document/publication (not including logos) free of charge in any format or medium. You must re-use it accurately and not in a misleading context.

The material must be acknowledged as Fylde Borough Council copyright and you must give the title of the source document/publication.

Where we have identified any third party copyright material you will need to obtain permission from the copyright holders concerned.

This document/publication is also available on our website at [www.fylde.gov.uk](http://www.fylde.gov.uk)

Any enquiries regarding this document/publication should be sent to us at the Town Hall, St Annes Road West, St Annes FY8 1LW, or to [listening@fylde.gov.uk](mailto:listening@fylde.gov.uk).



## LICENSING ACT 2003

### THE LICENSING ACT 2003 (HEARINGS) REGULATIONS 2005

#### PROCEDURE FOR THE CONDUCT OF HEARINGS

#### **1. Preliminary**

- 1.1. Under the regulations, the Licensing Authority is required to determine the procedure that it proposes to follow at any hearing under the Act. This document sets out the procedure that Fylde will normally follow.
- 1.2. A panel may decide to follow a different procedure at any hearing. If it does, it will specifically draw attention to any departures from the procedures set out in this document and the reasons for them.
- 1.3. Please refer to the regulations for other rules about procedure

#### **2. Interpretation**

In this procedure, the following words or phrases have the following meanings:

applicant	an applicant for a licence or any person who has a licence which may be reviewed or revoked as a result of the hearing
act	The Licensing Act 2003
licence	Includes any consent or permission under the act
panel	A sub-committee established by Fylde Borough Council under section 10 of the act
regulations	The Licensing Act 2003 (Hearings) Regulations 2003, and any reference to a numbered regulation is to the regulation so numbered in that statutory instrument
witness	A person given permission to appear at the hearing under regulation 8(2)

#### **3. Before the hearing**

- 3.1. At least ten days before the hearing, the panel will meet to consider:
  - 3.1.1. If the circumstances set out in regulation 9(1) apply, whether to dispense with holding a hearing;
  - 3.1.2. What, if any, particular points it considers it will want clarification on at the hearing from a party under regulation 7(1)(d), and
  - 3.1.3. What time limit to set under regulation 24.
- 3.2. If it is not practicable for the panel to meet to consider these matters, the convenor may ascertain the views of panel members separately and give effect to the majority view as if it had been reached in a meeting of the panel.

#### **4. *Opening the hearing***

- 4.1. The convenor will identify all parties to the hearing who are present. The convenor will also identify any persons who are present who intend to assist or represent any party and any witnesses.
- 4.2. The convenor will then explain to the parties the procedure to be followed at the hearing, specifically drawing attention to any departures from the procedures set out in this document and the reasons for them. The convenor will also inform the parties that the proceedings will be recorded.
- 4.3. The panel will then consider any request by a party under regulation 8(2) for another person to appear at the hearing. The convenor will give any party who has made such a request (or their representative) which the panel proposes to deny an opportunity to address the panel about their request. The panel will then re-consider the request.
- 4.4. The convenor may invite any officer to carry out any functions under this paragraph.

#### **5. *Listening to the parties***

- 5.1. Each of the parties will then be invited to:
  - 5.1.1. Open their case by addressing the panel;
  - 5.1.2. Give any further information requested by the panel under regulation 7(1)(d);
  - 5.1.3. Present the evidence of any witness; and
  - 5.1.4. Conclude their case by addressing the panel.
- 5.2. The order in which the parties will be invited to put their cases will be in the discretion of the panel, except that a party who is an applicant will be invited to put their case last.

#### **6. *Questioning the parties***

- 6.1. Members of the panel may, following the conclusion of the case of each party, ask questions of that party or any witness appearing for them.
- 6.2. A party or their representative may only question another party if they have asked for permission from the panel after the panel members have finished questioning that party or their witness. The panel will only give permission if it is satisfied that the questioning will provide useful information about a matter relevant to their determination which is unlikely to be placed before the panel without such questioning

#### **7. *Time limits***

Each party will be limited to the time set by the panel under regulation 24 in which to exercise their rights provided in paragraphs 5 and 6.2. The convenor will require the party or their representative to close their case or cease their questioning immediately this time limit is reached.

#### **8. *Considering the decision***

- 8.1. The panel will consider their decision in private.
- 8.2. No officers will retire with the panel except for the committee administrator. The committee administrator may, if requested to do so, provide procedural, but not legal or technical, advice to the panel. The committee administrator will also assist the panel by drafting and finalising the wording of the panel's decision, if requested by the panel.
- 8.3. The panel may, while it is considering its decision, seek advice from legal or licensing officers. Officers will limit their advice to the specific issue identified by the panel and will leave the room where the panel is considering its decision as soon as that advice has been given and understood.

#### **9. *Announcing the decision***

- 9.1. When the panel has made its decision, the public part of the meeting will resume.
- 9.2. The convenor will read out the decision of the panel, or may invite the committee administrator to do so. The meeting will then close or move on to the next business.

## DECISION ITEM

REPORT OF	MEETING	DATE	ITEM NO
RESOURCES DIRECTORATE	LICENSING PANEL	7 DECEMBER 2017	3
<b>APPLICATION FOR THE GRANT OF A PREMISES LICENCE MORRISONS DAILY FILLING STATION, SQUIRES GATE LANE, BLACKPOOL</b>			

### PUBLIC ITEM

This item is for consideration in the public part of the meeting.

### SUMMARY

The Licensing Authority has received an application for the grant of a premises licence for Morrisons Daily Filling Station. There has been a representation from an “other person” as defined by the Act and as such a hearing must be held to determine the application.

### RECOMMENDATION

- That the Panel considers the application and determines to either:
  - grant the application subject to the conditions specified in the operating schedule modified to such extent as the panel considers appropriate for the promotion of the licensing objectives, and any mandatory condition,
  - exclude from the scope of the licence any of the licensable activities to which the application relates ,
  - refuse to specify a person in the licence as premises supervisor,
  - reject the application

### SUMMARY OF PREVIOUS DECISIONS

There are no previous decisions relating to this matter.

CORPORATE PRIORITIES	
Spending your money in the most efficient way to achieve excellent services ( <b>Value for Money</b> )	✓
Delivering the services that customers expect of an excellent council ( <b>Clean and Green</b> )	✓
Working with all partners ( <b>Vibrant Economy</b> )	✓
To make sure Fylde continues to be one of the most desirable places to live ( <b>A Great Place to Live</b> )	✓
Promoting Fylde as a great destination to visit ( <b>A Great Place to Visit</b> )	✓

## REPORT

### Application

1. The application is for the grant of a premises licence at Morrisons Daily Petrol Filling Station, Squires Gate Lane, Blackpool.
2. The matter has been referred to the panel because a relevant representation has been received from an “other person” as defined by the Act.

### Papers

3. The following papers are relevant and have been made available to panel members:
  - The application, including the plan and the operating schedule
  - The Statutory Guidance for Licensing Authorities issued by the Secretary of State under section 182 of the Licensing Act 2003
  - The Council’s Statement of Licensing Policy
  - Copies of relevant representations made by the following responsible authorities:

None received
  - Copies of relevant representations made by the following interested parties  
Peter Steeden

### Consideration

4. The licensing objectives are:
  - The prevention of crime and disorder;
  - Public safety
  - The prevention of public nuisance; and
  - The protection of children from harm
5. As a relevant representation has been made, it is the duty of the panel to take such of the steps set out below as it considers appropriate for the promotion of the licensing objectives. The steps are:
  - (a) grant the application subject to the conditions specified in the operating schedule modified to such extent as the panel considers appropriate for the promotion of the licensing objectives, and any mandatory condition;
  - (b) exclude from the scope of the licence any of the licensable activities to which the application relates
  - (c) refuse to specify a person in the licence as premises supervisor; or
  - (d) reject the application
6. The Guidance issued by the Secretary of State and the Council’s Statement of Licensing Policy will be material in considering the application, but cannot override the licensing objectives.
7. The following parts of the secretary of state’s guidance appear to be particularly relevant to the application and the relevant representations:

2.14	Public Nuisance
8..12	Other persons
9.30	Hearings
9.41	Determining actions that are appropriate for the promotion of the licensing objectives.

However, the parties appearing in the hearing may wish to draw the panel’s attention to other parts of the guidance.

8. The following parts of the council's statement of licensing policy appear to be particularly relevant to the application and the relevant representations:

7	General approach to licensing
9.5	Licensing Panel Hearings
18	Need for licensed premises
10.3	Conditions that the Licensing Authority May Impose

However, the parties appearing in the hearing may wish to draw the panel's attention to other parts of the policy.

#### Further Information

9. Following a representation by the Police, the applicant has agreed a condition as detailed below. The Panel are requested to consider attaching this condition to the licence.

10. The condition is:

- i) Between the hours of 2300 and 0500 the shop retail area of the premises will not be open to the public and all sales will be made through the night serving hatch.

#### Procedure

11. The applicant and the makers of the relevant representations have been invited to attend or be represented at the hearing.
12. The panel is asked to use the attached procedure in the hearing.

IMPLICATIONS	
Finance	No further implications arising directly from the report.
Legal	No further implications arising directly from the report.
Community Safety	No further implications arising directly from the report.
Human Rights and Equalities	No further implications arising directly from the report.
Sustainability and Environmental Impact	No further implications arising directly from the report.
Health & Safety and Risk Management	No further implications arising directly from the report.

LEAD AUTHOR	CONTACT DETAILS	DATE
Chris Hambly	<a href="mailto:chris.hambly@fylde.gov.uk">chris.hambly@fylde.gov.uk</a> Tel 01253 658422	17 <sup>th</sup> November 2017

BACKGROUND PAPERS		
Name of document	Date	Where available for inspection
S182 Statement of Licensing Policy	April 2017	<a href="#">S182 Guidance</a>
Fylde Council Statement of Licensing Policy	January 2016	<a href="#">Statement of Licensing Policy</a>

Attached documents

Application Form  
Plan of Premises  
Representation  
Area Plan

## Application for a Premises Licence to be Granted under the Licensing Act 2003

### PLEASE READ THE FOLLOWING INSTRUCTIONS FIRST

Before completing this form please read the guidance notes at the end of the form. If you are completing this form by hand please write legibly in block capitals. In all cases ensure that your answers are inside the boxes and written in black ink. Use additional sheets if necessary. You may wish to keep a copy of the completed form for your records.

(1) Delete as applicable.  
(2) Insert name(s) of applicant.

(1) ~~I~~ **[We]** (2)

WM MORRISON SUPERMARKETS PLC

**apply for a premises licence under section 17 of the Licensing Act 2003 for the premises described in Part 1 below (the premises) and (1) ~~I am~~ **[we are]** making this application to you as the relevant licensing authority in accordance with section 12 of the Licensing Act 2003**

### Part 1 - Premises Details

Postal address of premises or, if none, ordnance survey map reference or description MORRISONS DAILY PETROL FILLING STATION SQUIRES GATE LANE			
Post town	BLACKPOOL	Postcode	FY4 2AY
Telephone number at premises (if any)			
Non-domestic rateable value of premises		£	

### Part 2 - Applicant Details

Please state whether you are applying for a premises licence as

Please tick as appropriate

- |   |  |
|---|--|
| <p>(a) an individual or individuals*</p> <p>(b) a person other than an individual*</p> <p style="padding-left: 20px;">(i) as a limited company/limited liability partnership</p> <p style="padding-left: 20px;">(ii) as a partnership (other than limited liability)</p> <p style="padding-left: 20px;">(iii) as an unincorporated association or</p> <p style="padding-left: 20px;">(iv) other (for example a statutory corporation)</p> <p>(c) a recognised club</p> <p>(d) a charity</p> <p>(e) the proprietor of an educational establishment</p> <p>(f) a health service body</p> <p>(g) a person who is registered under Part 2 of the Care Standards Act 2000 (c14) in respect of an independent hospital in Wales</p> <p>(ga) a person who is registered under Chapter 2 of Part 1 of the Health and Social Care Act 2008 (within the meaning of that Part) in an independent hospital in England</p> | <p><input type="checkbox"/> please complete section (A)</p> <p><input checked="" type="checkbox"/> please complete section (B)</p> <p><input type="checkbox"/> please complete section (B)</p> <p><input type="checkbox"/> please complete section (B)</p> <p><input type="checkbox"/> please complete section (B)</p> <p><input type="checkbox"/> please complete section (B)</p> <p><input type="checkbox"/> please complete section (B)</p> <p><input type="checkbox"/> please complete section (B)</p> <p><input type="checkbox"/> please complete section (B)</p> <p><input type="checkbox"/> please complete section (B)</p> |
|---|--|



(h) the chief officer of police of a police force  
in England and Wales

☐ please complete section (B)

\*If you are applying as a person described in (a) or (b) please confirm (by ticking yes to one box below):

Please tick yes

- I am carrying on or proposing to carry on a business which involves the use of the premises for licensable activities; or ☒
- I am making the application pursuant to a
  - statutory function or ☐
  - a function discharged by virtue of Her Majesty's prerogative ☐

**(A) INDIVIDUAL APPLICANTS** (fill in as applicable)

Mr	<input type="checkbox"/>	Mrs	<input type="checkbox"/>	Miss	<input type="checkbox"/>	Ms	<input type="checkbox"/>	Other Title (for example, Rev.)	
<b>Surname</b>					<b>First names</b>				
<b>Date of birth</b>					I am 18 years old or over <input type="checkbox"/> Please tick yes				
<b>Nationality</b>									
Current residential address if different from premises address									
Post town						Postcode			
<b>Daytime contact telephone number</b>									
<b>E-mail address (optional)</b>									

**SECOND INDIVIDUAL APPLICANT** (if applicable)

Mr	<input type="checkbox"/>	Mrs	<input type="checkbox"/>	Miss	<input type="checkbox"/>	Ms	<input type="checkbox"/>	Other Title (for example, Rev.)	
<b>Surname</b>					<b>First names</b>				
<b>Date of birth</b>					I am 18 years old or over <input type="checkbox"/> Please tick yes				
<b>Nationality</b>									
Current residential address if different from premises address									
Post town						Postcode			
<b>Daytime contact telephone number</b>									
<b>E-mail address (optional)</b>									

**(B) OTHER APPLICANTS**

Please provide name and registered address of applicant in full. Where appropriate please give any registered number. In the case of a partnership or other joint venture (other than a body corporate), please give the name and address of each party concerned.

Name	WM MORRISON SUPERMARKETS PLC
Address	HILMORE HOUSE GAIN LANE BRADFORD BD3 7DL
Registered number (where applicable)	00358949
Description of applicant (for example, partnership, company, unincorporated association etc.)	COMPANY
Telephone number (if any)	
E-mail address (optional)	

**Part 3 - Operating Schedule**

When do you want the premises licence to start?

DD		MM		YYYY			
1	7	1	1	2	0	1	7

If you wish the licence to be valid only for a limited period, when do you want it to end?

DD		MM		YYYY			

Please give a general description of the premises (please read guidance note 1)

CONVENIENCE STORE / PETROL FILLING STATION

If 5,000 or more people are expected to attend the premises at any one time, please state the number expected to attend.

--

What licensable activities do you intend to carry on from the premises?

(Please see sections 1 and 14 of the Licensing Act 2003 and Schedules 1 and 2 to the Licensing Act 2003)

**Provision of regulated entertainment**

Please tick all that apply

(a) plays (if ticking yes, fill in box A)

☐

(b) films (if ticking yes, fill in box B)

☐

(c) indoor sporting events (if ticking yes, fill in box C)

☐

(d) boxing or wrestling entertainment (if ticking yes, fill in box D)

☐

(e) live music (if ticking yes, fill in box E)

☐

(f) recorded music (if ticking yes, fill in box F)

☐

(g) performances of dance (if ticking yes, fill in box G)

☐

(h) anything of a similar description to that falling within (e), (f) or (g)  
(if ticking yes, fill in box H)

☐

**Provision of late night refreshment** (if ticking yes, fill in box I)

☒

**Supply of alcohol** (if ticking yes, fill in box J)

☒

**In all cases complete boxes K, L and M**

**A**

<b>Plays</b> Standard days and timings (please read guidance note 7)			<b>Will the performance of a play take place indoors or outdoors or both - please tick</b> (please read guidance note 3)	Indoors	<input type="checkbox"/>
				Outdoors	<input type="checkbox"/>
				Both	<input type="checkbox"/>
Day	Start	Finish	<b>Please give further details here</b> (please read guidance note 4)		
Mon					
Tue			<b>State any seasonal variations for performing plays</b> (please read guidance note 5)		
Wed					
Thur					
Fri			<b>Non standard timings. Where you intend to use the premises for the performance of plays at different times to those listed in the column on the left, please list</b> (please read guidance note 6)		
Sat					
Sun					

**B**

<b>Films</b> Standard days and timings (please read guidance note 7)			<b>Will the exhibition of films take place indoors or outdoors or both - please tick</b> (please read guidance note 3)	Indoors	<input type="checkbox"/>
				Outdoors	<input type="checkbox"/>
				Both	<input type="checkbox"/>
Day	Start	Finish	<b>Please give further details here</b> (please read guidance note 4)		
Mon					
Tue			<b>State any seasonal variations for the exhibition of films</b> (please read guidance note 5)		
Wed					
Thur					
Fri			<b>Non standard timings. Where you intend to use the premises for the exhibition of films at different times to those listed in the column on the left, please list</b> (please read guidance note 6)		
Sat					
Sun					

C

<b>Indoor sporting events</b> Standard days and timings (please read guidance note 7)			<b><u>Please give further details</u></b> (please read guidance note 4)
Day	Start	Finish	
Mon			
Tue			<b><u>State any seasonal variations for indoor sporting events</u></b> (please read guidance note 5)
Wed			
Thur			
Fri			<b><u>Non standard timings. Where you intend to use the premises for indoor sporting events at different times to those listed in the column on the left, please list</u></b> (please read guidance note 6)
Sat			
Sun			

D

<b>Boxing or wrestling entertainments</b> Standard days and timings (please read guidance note 7)			<b><u>Will the boxing or wrestling entertainment take place indoors or outdoors or both - please tick</u></b> (please read guidance note 3)	Indoors	<input type="checkbox"/>
				Outdoors	<input type="checkbox"/>
				Both	<input type="checkbox"/>
Day	Start	Finish	<b><u>Please give further details here</u></b> (please read guidance note 4)		
Mon					
Tue					
Wed					
Thur			<b><u>State any seasonal variations for boxing or wrestling entertainment</u></b> (please read guidance note 5)		
Fri			<b><u>Non standard timings. Where you intend to use the premises for boxing or wrestling entertainment at different times to those listed in the column on the left, please list</u></b> (please read guidance note 6)		
Sat					
Sun					

**E**

<b>Live music</b> Standard days and timings (please read guidance note 7)			<b><u>Will the performance of live music take place indoors or outdoors or both - please tick</u></b> (please read guidance note 3)	Indoors	<input type="checkbox"/>
				Outdoors	<input type="checkbox"/>
				Both	<input type="checkbox"/>
Day	Start	Finish	<b><u>Please give further details here</u></b> (please read guidance note 4)		
Mon					
Tue					
Wed			<b><u>State any seasonal variations for the performance of live music</u></b> (please read guidance note 5)		
Thur					
Fri			<b><u>Non standard timings. Where you intend to use the premises for the performance of live music at different times to those listed in the column on the left, please list</u></b> (please read guidance note 6)		
Sat					
Sun					

**F**

<b>Recorded music</b> Standard days and timings (please read guidance note 7)			<b><u>Will the playing of recorded music take place indoors or outdoors or both - please tick</u></b> (please read guidance note 3)	Indoors	<input type="checkbox"/>
				Outdoors	<input type="checkbox"/>
				Both	<input type="checkbox"/>
Day	Start	Finish	<b><u>Please give further details here</u></b> (please read guidance note 4)		
Mon					
Tue					
Wed			<b><u>State any seasonal variations for the playing of recorded music</u></b> (please read guidance note 5)		
Thur					
Fri			<b><u>Non standard timings. Where you intend to use the premises for the playing of recorded music at different times to those listed in the column on the left, please list</u></b> (please read guidance note 6)		
Sat					
Sun					

**G**

<b>Performances of dance</b> Standard days and timings (please read guidance note 7)			<b>Will the performance of dance take place indoors or outdoors or both - please tick</b> (please read guidance note 3)		Indoors	<input type="checkbox"/>
					Outdoors	<input type="checkbox"/>
					Both	<input type="checkbox"/>
Day	Start	Finish	<b>Please give further details here</b> (please read guidance note 4)			
Mon						
Tue						
Wed			<b>State any seasonal variations for the performance of dance</b> (please read guidance note 5)			
Thur						
Fri						
Sat			<b>Non standard timings. Where you intend to use the premises for the performance of dance at different times to those listed in the column on the left, please list</b> (please read guidance note 6)			
Sun						

**H**

<b>Anything of a similar description to that falling within (e), (f) or (g)</b> Standard days and timings (please read guidance note 7)			<b>Please give a description of the type of entertainment you will be providing</b>		<b>Will this entertainment take place indoors or outdoors or both - please tick</b> (please read guidance note 3)			
							Indoors	<input type="checkbox"/>
							Outdoors	<input type="checkbox"/>
Day	Start	Finish	<b>Please give further details here</b> (please read guidance note 4)		<b>Both</b> <input type="checkbox"/>			
Mon								
Tue								
Wed			<b>State any seasonal variations for entertainment of a similar description to that falling within (e), (f) or (g)</b> (please read guidance note 5)					
Thur								
Fri								
Sat			<b>Non standard timings. Where you intend to use the premises for the entertainment of a similar description to that falling within (e), (f) or (g) at different times to those listed in the column on the left, please list</b> (please read guidance note 6)					
Sun								

<b>Late night refreshment</b> Standard days and timings (please read guidance note 7)			<b>Will the provision of late night refreshment take place indoors or outdoors or both - please tick</b> (please read guidance note 3)	Indoors	<input type="checkbox"/>
				Outdoors	<input type="checkbox"/>
				Both	<input checked="" type="checkbox"/>
Day	Start	Finish	<b>Please give further details here</b> (please read guidance note 4)		
Mon	2300	0500			
Tue	2300	0500			
Wed	2300	0500			
Thur	2300	0500	<b>State any seasonal variations for the provision of late night refreshment</b> (please read guidance note 5)		
Fri	2300	0500			
Sat	2300	0500			
Sun	2300	0500			
			<b>Non standard timings. Where you intend to use the premises for the provision of late night refreshment at different times to those listed in the column on the left, please list</b> (please read guidance note 6)		

<b>Supply of alcohol</b> Standard days and timings (please read guidance note 7)			<b>Will the supply of alcohol be for consumption - please tick</b> (please read guidance note 8)	On the premises	<input type="checkbox"/>
				Off the premises	<input checked="" type="checkbox"/>
				Both	<input type="checkbox"/>
Day	Start	Finish	<b>State any seasonal variations for the supply of alcohol</b> (please read guidance note 5)		
Mon	0000	2400			
Tue	0000	2400			
Wed	0000	2400			
Thur	0000	2400	<b>Non standard timings. Where you intend to use the premises for the supply of alcohol at different times to those listed in the column on the left, please list</b> (please read guidance note 6)		
Fri	0000	2400			
Sat	0000	2400			
Sun	0000	2400			

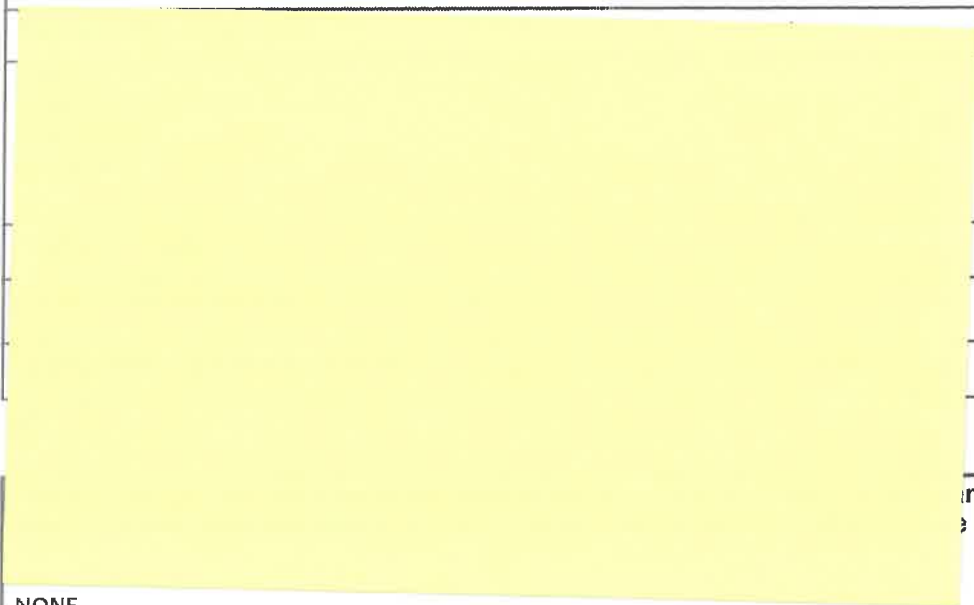

State the name and details of the individual whom you wish to specify on the licence as designated premises supervisor (Please see declaration about the entitlement to work in the checklist at the end of the form):

Name	KELLY LOUISE NICHOLS
	
<p>ment or matters ancillary to the read guidance note 9)</p>	
NONE.	

L

<b>Hours premises are open to the public</b> Standard days and timings (please read guidance note 7)			<b>State any seasonal variations</b> (please read guidance note 5)
Day	Start	Finish	<b>Non standard timings. Where you intend the premises to be open to the public at different times to those listed in the column on the left, please list</b> (please read guidance note 6)
Mon	0000	2400	
Tue	0000	2400	
Wed	0000	2400	
Thur	0000	2400	
Fri	0000	2400	
Sat	0000	2400	
Sun	0000	2400	

**M**

**Describe the steps you intend to take to promote the four licensing objectives:**

**(a) General - all four licensing objectives (b, c, d and e) (please read guidance note 10)**

ALL STAFF ENGAGED IN THE SALE OF ALCOHOL WILL BE TRAINED IN ACCORDANCE WITH THE PREMISES LICENCE HOLDER'S TRAINING PROCEDURES.

**(b) The prevention of crime and disorder**

ALL STAFF ENGAGED IN THE SALE OF ALCOHOL WILL RECEIVE SUITABLE TRAINING (INCLUDING REFRESHER TRAINING) IN RELATION TO THE PROOF OF AGE "CHALLENGE 25" SCHEME TO BE APPLIED ON THE PREMISES. THE FOLLOWING FORMS OF IDENTIFICATION ARE ACCEPTABLE: PHOTO DRIVING LICENCE, PASSPORT, PROOF OF AGE STANDARDS SCHEME (PASS) CARD, MILITARY ID AND ANY OTHER LOCALLY OR NATIONALLY APPROVED FORM OF IDENTIFICATION.

CCTV SHALL BE PROVIDED ON THE PREMISES AND SHALL BE KEPT IN GOOD WORKING ORDER.

ALL CHECKOUT OPERATORS WILL OPERATE A REFUSAL LOG.

**(c) Public safety**

THE PREMISES LICENCE HOLDER UNDERTAKES ONGOING RISK ASSESSMENTS IN ORDER TO COMPLY WITH HEALTH & SAFETY LEGISLATION.

**(d) The prevention of public nuisance**

THE PREMISES ARE RESPONSIBLY MANAGED AND SUPERVISED. NO ADDITIONAL MEASURES ARE BELIEVED NECESSARY.

**(e) The protection of children from harm**

ALL STAFF ENGAGED IN THE SALE OF ALCOHOL WILL RECEIVE SUITABLE TRAINING (INCLUDING REFRESHER TRAINING) IN RELATION TO THE PROOF OF AGE "CHALLENGE 25" SCHEME TO BE APPLIED ON THE PREMISES. THE FOLLOWING FORMS OF IDENTIFICATION ARE ACCEPTABLE: PHOTO DRIVING LICENCE, PASSPORT, PROOF OF AGE STANDARDS SCHEME (PASS) CARD, MILITARY ID AND ANY OTHER LOCALLY OR NATIONALLY APPROVED FORM OF IDENTIFICATION.

TILL PROMPTS ARE IN USE AT THE STORE.

**Checklist:**

Please tick to indicate agreement

- I have made or enclosed payment of the fee. ☒
- I have enclosed the plan of the premises. ☒
- I have sent copies of this application and the plan to responsible authorities and others where applicable. ☒
- I have enclosed the consent form completed by the individual I wish to be designated premises supervisor, if applicable. ☒
- I understand that I must now advertise my application. ☒
- I understand that if I do not comply with the above requirements my application will be rejected. ☒
- [Applicable to all individual applicants, including those in a partnership which is not limited liability partnership] I have included documents demonstrating my entitlement to work in the United Kingdom (please read note 15). ☒

**IT IS AN OFFENCE, UNDER SECTION 158 OF THE LICENSING ACT 2003, TO MAKE A FALSE STATEMENT IN OR IN CONNECTION WITH THIS APPLICATION. THOSE WHO MAKE A FALSE STATEMENT MAY BE LIABLE ON SUMMARY CONVICTION TO A FINE OF ANY AMOUNT.**

**IT IS AN OFFENCE UNDER SECTION 24B OF THE IMMIGRATION ACT 1971 FOR A PERSON TO WORK WHEN THEY KNOW, OR HAVE REASONABLE CAUSE TO BELIEVE, THAT THEY ARE DISQUALIFIED FROM DOING SO BY REASON OF THEIR IMMIGRATION STATUS. THOSE WHO EMPLOY AN ADULT WITHOUT LEAVE OR WHO IS SUBJECT TO CONDITIONS AS TO EMPLOYMENT WILL BE LIABLE TO A CIVIL PENALTY UNDER SECTION 15 OF THE IMMIGRATION, ASYLUM AND NATIONALITY ACT 2006 AND PURSUANT TO SECTION 21 OF THE SAME ACT, WILL BE COMMITTING AN OFFENCE WHERE THEY DO SO IN THE KNOWLEDGE, OR WITH REASONABLE CAUSE TO BELIEVE, THAT THE EMPLOYEE IS DISQUALIFIED.**

**Part 4 - Signatures** (please read guidance note 11)

**Signature of applicant or applicant's solicitor or other duly authorised agent** (see guidance note 12).  
**If signing on behalf of the applicant, please state in what capacity.**

Declaration	<ul style="list-style-type: none"> <li>[ Applicable to individual applicants only, including those in a partnership which is not a limited liability partnership] I understand I am not entitled to be issued with a licence if I do not have the entitlement to live and work in the UK (or if I am subject to a condition preventing me from doing work relating to the carrying on of a licensable activity) and that my licence will become invalid if I cease to be entitled to live and work in the UK (please read guidance note 15).</li> <li>The DPS named in this application form is entitled to work in the UK (and is not subject to conditions preventing him or her from doing work relating to a licensable activity) and I have seen a copy of his or her proof of entitlement to work, if appropriate (please see note 15)</li> </ul>		
Signature	<i>Gosschalks</i>		
Date	18 OCTOBER 2017		
Capacity	SOLICITORS ON BEHALF OF THE APPLICANT		
<b>For joint applications, signature of 2nd applicant or 2nd applicant's solicitor or other authorised agent</b> (please read guidance note 12). <b>If signing on behalf of the applicant, please state in what capacity.</b>			
Signature			
Date			
Capacity			
Contact name (where not previously given) and postal address for correspondence associated with this application (please read guidance note 14) Gosschalks Solicitors Queens Gardens Hull DX 11902 Hull			
Post town		Postcode	HU1 3DZ
Telephone number (if any)	01482 324252		
If you would prefer us to correspond with you by e-mail, your e-mail address (optional) info@gosschalks.co.uk			

## Notes for Guidance

1. Describe the premises, for example the type of premises, its general situation and layout and any other information which could be relevant to the licensing objectives. Where your application includes off-supplies of alcohol and you intend to provide a place for consumption of these off-supplies, you must include a description of where the place will be and its proximity to the premises.
2. In terms of specific regulated entertainments please note that:
  - Plays: no licence is required for performances between 08:00 and 23.00 on any day, provided that the audience does not exceed 500.
  - Films: no licence is required for 'not-for-profit' film exhibition held in community premises between 08.00 and 23.00 on any day provided that the audience does not exceed 500 and the organiser (a) gets consent to the screening from a person who is responsible for the premises; and (b) ensures that each such screening abides by age classification ratings.
  - Indoor sporting events: no licence is required for performances between 08.00 and 23.00 on any day, provided that the audience does not exceed 1000.
  - Boxing or Wrestling Entertainment: no licence is required for a contest, exhibition or display of Greco-Roman wrestling, or freestyle wrestling between 08.00 and 23.00 on any day, provided that the audience does not exceed 1000. Combined fighting sports- defined as a contest, exhibition or display which combines boxing or wrestling with one or more martial arts- are licensable as a boxing or wrestling entertainment rather than an indoor sporting event.
  - Live music: no licence permission is required for:
    - a performance of unamplified live music between 08.00 and 23.00 on any day, on any premises.
    - a performance of amplified live music between 08.00 and 23.00 on any day on premises authorised to sell alcohol for consumption on those premises, provided that the audience does not exceed 500.
    - a performance of amplified live music between 08.00 and 23.00 on any day, in a workplace that is not licensed to sell alcohol on those premises, provided that the audience does not exceed 500.
    - a performance of amplified live music between 08.00 and 23.00 on any day, in a church hall, village hall, community hall, or other similar community premises, that is not licensed by a premises licence to sell alcohol, provided that (a) the audience does not exceed 500, and (b) the organiser gets consent for the performance from a person who is responsible for the premises.
    - a performance of amplified live music between 08.00 and 23.00 on any day, at the non-residential premises of (i) a local authority, or (ii) a school, or (iii) a hospital, provided that (a) the audience does not exceed 500, and (b) the organiser gets consent for the performance on the relevant premises from: (i) the local authority concerned, or (ii) the school or (iii) the health care provider for the hospital.
  - Recorded Music: no licence permission is required for;
    - any playing of recorded music between 08.00 and 23.00 on any day on premises authorised to sell alcohol for consumption on those premises, provided that the audience does not exceed 500.
    - any playing of recorded music between 08.00 and 23.00 on any day, in a church hall, village hall, community hall, or other similar community premises, that is not licensed by a premises licence to sell alcohol, provided that (a) the audience does not exceed 500, and (b) the organiser gets consent for the performance from a person who is responsible for the premises.
    - any playing of recorded music between 08.00 and 23.00 on any day, at the non-residential premises of (i) a local authority, or (ii) a school, or (iii) a hospital, provided that (a) the audience does not exceed 500, and (b) the organiser gets consent for the performance on the relevant premises from: (i) the local authority concerned, or (ii) the school proprietor or (iii) the health care provider for the hospital.
  - Dance: no licence is required for performances between 08.00 and 23.00 on any day, provided that the audience does not exceed 500. However, a performance which amounts to adult entertainment remains licensable.
  - Cross activity exemptions: no licence is required between 08.00 and 23.00 on any day, with no limit on audience size for:
    - any entertainment taking place on the premises of the local authority where the entertainment is provided by or on behalf of the local authority;
    - any entertainment taking place on the hospital premises of the health care provider where the entertainment is provided by or on behalf of the health care provider;
    - any entertainment taking place on the premises of the school where the entertainment is provided by or on behalf of the school proprietor; and
    - any entertainment (excluding films and a boxing or wrestling entertainment) taking place at a travelling circus, provided that (a) it takes place within a moveable structure that accommodates the audience, and (b) that the travelling circus has not been located on the same site for more than 28 consecutive days.
3. Where taking place in a building or other structure please tick as appropriate (indoors may include a tent.)

4. For example the type of activity to be authorised, if not already stated, and give relevant further details, for example (but not exclusively) whether or not music will be amplified or unamplified.
5. For example (but not exclusively), where the activity will occur on additional days during the summer months.
6. For example (but not exclusively), where you wish the activity to go on longer on a particular day e.g. Christmas Eve.
7. Please give timings in 24 hour clock (e.g. 16:00) and only give details for the days of the week when you intend the premises to be used for the activity.
8. If you wish people to be able to consume alcohol on the premises, please tick 'on the premises'. If you wish people to be able to purchase alcohol to consume away from the premises, please tick 'off the premises'. If you wish people to be able to do both, please tick 'both'.
9. Please give information about anything intended to occur at the premises or ancillary to the use of the premises which may give rise to concern in respect of children, regardless of whether you intend children to have access to the premises, for example (but not exclusively) nudity or semi-nudity, films for restricted age groups or the presence of gaming machines.
10. Please list here steps you will take to promote all four licensing objectives together.
11. The application form must be signed.
12. An applicant's agent (for example solicitor) may sign the form on their behalf provided that they have actual authority to do so.
13. Where there is more than one applicant, each of the applicants or their respective agent must sign the application form.
14. This is the address which we shall use to correspond with you about this application.
15. **Entitlement to work/immigration status for individual applicants and applications from partnerships which are not limited liability partnerships:**

A licence may not be held by an individual or an individual in a partnership who is resident in the UK who:

- does not have the right to live and work in the UK; or
- is subject to a condition preventing him or her from doing work relating to the carrying on of a licensable activity.

Any premises licence issued in respect of an application made on or after 6 April 2017 will become invalid if the holder ceases to be entitled to work in the UK.

Applicants must demonstrate that they have an entitlement to work in the UK and are not subject to a condition preventing them from doing work relating to the carrying on of a licensable activity. They do this by providing with this application copies or scanned copies of the following documents (which do not need to be certified).

#### **Documents which demonstrate entitlement to work in the UK**

- An expired or current passport showing the holder, or a person named in the passport as the child of the holder, is a British citizen or a citizen of the UK and Colonies having the right of abode in the UK [please see note below about which sections of the passport to copy].
- An expired or current passport or national identity card showing the holder, or a person named in the passport as the child of the holder, is a national of a European Economic Area country or Switzerland.
- A Registration Certificate or document certifying permanent residence issued by the Home Office to a national of a European Economic Area country or Switzerland.
- A Permanent Residence Card issued by the Home Office to the family member of a national of a European Economic Area country or Switzerland.
- A **current** Biometric Immigration Document (Biometric Residence Permit) issued by the Home Office to the holder indicating that the person named is allowed to stay indefinitely in the UK, or has no time limit on their stay in the UK.
- A **current** passport endorsed to show that the holder is exempt from immigration control, is allowed to stay indefinitely in the UK, has the right of abode in the UK, or has no time limit on their stay in the UK.
- A **current** Immigration Status Document issued by the Home Office to the holder with an endorsement indicating that the named person is allowed to stay indefinitely in the UK or has no time limit on their stay in the UK, **when produced in combination with** an official document giving the person's permanent National Insurance number and their name issued by a Government agency or a previous employer.
- A **full** birth or adoption certificate issued in the UK which includes the name(s) of at least one of the holder's parents or adoptive parents, **when produced in combination with** an official document giving the person's permanent National Insurance number and their name issued by a Government agency or a previous employer.
- A birth or adoption certificate issued in the Channel Islands, the Isle of Man or Ireland **when produced in combination with** an official document giving the person's permanent National Insurance number and their name issued by a Government agency or a previous employer.

- A certificate of registration or naturalisation as a British citizen, **when produced in combination with** an official document giving the person's permanent National Insurance number and their name issued by a Government agency or a previous employer.
- A **current** passport endorsed to show that the holder is allowed to stay in the UK and is currently allowed to work and is not subject to a condition preventing the holder from doing work relating to the carrying on of a licensable activity.
- A **current** Biometric Immigration Document (Biometric Residence Permit) issued by the Home Office to the holder which indicates that the named person can currently stay in the UK and is allowed to work in relation to the carrying on of a licensable activity.
- A **current** Residence Card issued by the Home Office to a person who is not a national of a European Economic Area state or Switzerland but who is a family member of such a national or who has derivative rights of residence.
- A **current** Immigration Status Document containing a photograph issued by the Home Office to the holder with an endorsement indicating that the named person may stay in the UK, and is allowed to work and is not subject to a condition preventing the holder from doing work relating to the carrying on of a licensable activity **when produced in combination with** an official document giving the person's permanent National Insurance number and their name issued by a Government agency or a previous employer.
- A Certificate of Application, **less than 6 months old**, issued by the Home Office under regulation 17(3) or 18A (2) of the Immigration (European Economic Area) Regulations 2006, to a person who is not a national of a European Economic Area state or Switzerland but who is a family member of such a national or who has derivative rights of residence.
- Reasonable evidence that the person has an outstanding application to vary their permission to be in the UK with the Home Office such as the Home Office acknowledgement letter or proof of postage evidence, or reasonable evidence that the person has an appeal or administrative review pending on an immigration decision, such as an appeal or administrative review reference number.
- Reasonable evidence that a person who is not a national of a European Economic Area state or Switzerland but who is a family member of such a national or who has derivative rights of residence in exercising treaty rights in the UK including:-
- evidence of the applicant's own identity - such as a passport,
- evidence of their relationship with the European Economic Area family member e.g. a marriage certificate, civil partnership certificate or birth certificate, and
- evidence that the European Economic Area national has a right of permanent residence in the UK or is one of the following if they have been in the UK for more than 3 months:
  - (i) working e.g. employment contract, wage slips, letter from the employer,
  - (ii) self-employed e.g. contracts, invoices, or audited accounts with a bank,
  - (iii) studying e.g. letter from the school, college or university and evidence of sufficient funds; or
  - (iv) self-sufficient e.g. bank statements.

Family members of European Economic Area nationals who are studying or financially independent must also provide evidence that the European Economic Area national and any family members hold comprehensive sickness insurance in the UK. This can include a private medical insurance policy, an EHIC card or an SI, S2 or S3 form.

**Original documents must not be sent to licensing authorities.** If the document copied is a passport, a copy of the following pages should be provided:-

- (i) any page containing the holder's personal details including nationality;
- (ii) any page containing the holder's photograph;
- (iii) any page containing the holder's signature;
- (iv) any page containing the date of expiry; and
- (v) any page containing information indicating the holder has permission to enter or remain in the UK and is permitted to work.

If the document is not a passport, a copy of the whole document should be provided.

Your right to work will be checked as part of your licensing application and this could involve us checking your immigration status with the Home Office. We may otherwise share information with the Home Office. Your licence application will not be determined until you have complied with this guidance.

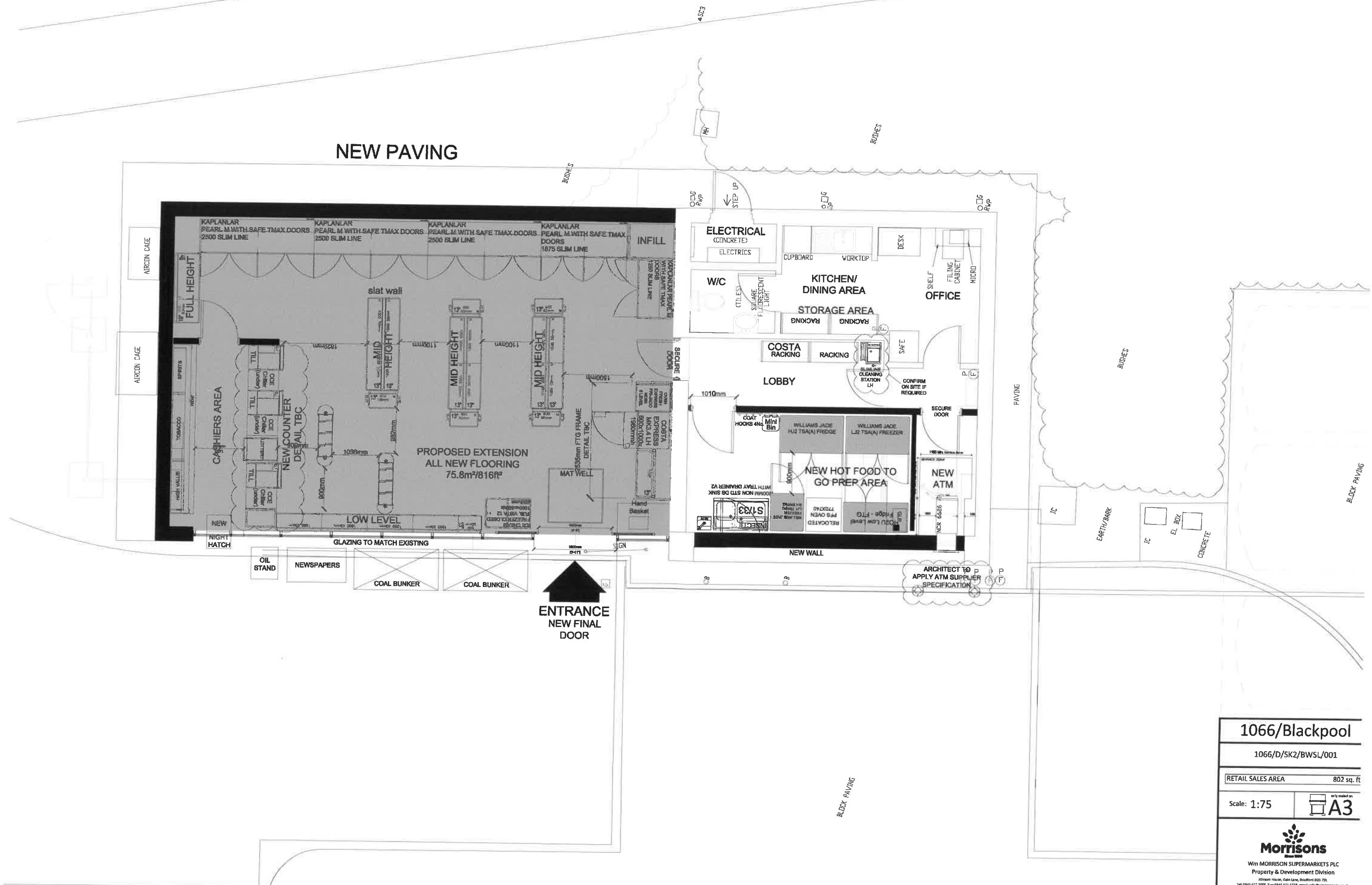

1066/Blackpool	
1066/D/SK2/BWSL/001	
RETAIL SALES AREA	802 sq. ft
Scale: 1:75	A3
Wm MORRISON SUPERMARKETS PLC Property & Development Division Hilltop House, Gains Lane, Bradford BD3 7JN Tel: 01454 611 5000 Fax: 01454 611 6738 email: info@wmproperty.co.uk	



-----Original Message-----

From: Peter Steeden [mailto:XXXXXXXXXXXXXXXXXX]

Sent: 10 November 2017 11:52

To: Andy Hough <andy.hough@fylde.gov.uk>

Subject: Re: Comment re: Licensing application for Morrisons petrol station

Good morning

Thank you for the update on the planning application.

Despite the concession, I still have concerns regarding the availability of alcohol during the night and would appreciate this objection being included when the panel considers the application.

Regards

Peter Steeden

On 10/11/2017 10:22, Andy Hough wrote:

> Good morning Mr Steeden

> I refer to your objection to the application for a Premises Licence at the new Morrison's Filing Station.

> I would advise that the police have no issues with Morrisons having a 24 hour licence at the filing station, but there are issues relating to that particular site in relation to anti-social behaviour and juvenile nuisance during the evening and through the night which they would need to safeguard against, due to the large car park and neighbouring 24hr McDonalds.

> Following discussions between the police and representatives from Morrisons the following condition has been agreed to resolve this issue.

> "Between the hours of 2300 and 0500 the shop retail area of the premises will not be open to the public and all sales will be made through the night serving hatch"

> So far we have not received any other representations.

> I wonder therefore whether this condition would address the issues that you raised in your initial email. If that is the case can you please advise by email that you wish to withdraw your representation.

> Should you not wish to withdraw then this matter will be the Council's Licensing Panel on Thursday 7th December at 2.30pm and a formal notification will be posted to you in due course.

> Should you wish to discuss this matter please ring on 01253 658606.

> I look forward to receiving your comments.

> Thanks Andy

>

> Andy Hough

> Technical Enforcement Officer - Licensing Team Fylde Borough Council

> DDI: 01253 658606

> Main: 01253 658658

-----Original Message-----

> From: Peter Steeden [mailto:XXXXXXXXXXXXXXXXXX ]

> Sent: 24 October 2017 10:26

> To: Joanne Gallagher <joanne.gallagher@fylde.gov.uk>

> Subject: Re: Comment re: Licensing application for Morrisons petrol  
> station

>

> Good morning  
> Yes, please register my statement as an objection  
> Regards  
> Peter Steeden

> On 24/10/2017 08:51, Joanne Gallagher wrote:

>> Hello Mr Steeden,  
>>

>> Thank you for your email. Please would you be able to confirm that you would like this to be treated as a formal representation (objection) against the granting of the premises licence for Morrisons Filling Station?

>> Kind regards

>> Joanne

>> Joanne Gallagher

>> Technical Enforcement Officer- Licensing Fylde Borough Council

>>

>> DDI: 01253 658609

>> Main: 01253 658609

>> -----Original Message-----

>> From: Peter Steeden [mailto:XXXXXXXXXXXXXXXXXX ]

>> Sent: 23 October 2017 19:46

>> To: Licencing <licensing@fylde.gov.uk>

>> Subject: Comment re: Licensing application for Morrisons petrol  
>> station

>>

>> Dear Sir/Madam

>>

>> I have seen a notice, in Morrison's supermarket, Squires Gate Lane, Blackpool , stating that the company has made an application for a 24 hour alcohol licence for their petrol station.

>> I strongly object to such a licence being issued and feel that licensing hours in line with the main supermarket opening hours (8 am - 10pm) or those of the nearby Bargain Booze store across from the Halfway House (7am - 10pm) are sufficient to meet the needs of normal drinkers. I feel that the only people likely to need to purchase alcohol outside these times would be those alcohol dependents who have exhausted their supply and need more.

>> Alcohol leads to serious health issues, anti-social behaviour, domestic violence and litter problems. It also increases the workload of NHS staff in Accident and Emergency.

>> I urge you to refuse the application from Morrisons for alcohol to be made freely available 24 hours a day.

>>

>> Regards

>> Peter Steeden

>> Parklands,

>> Chapel Road

>> Blackpool FY4 5HT

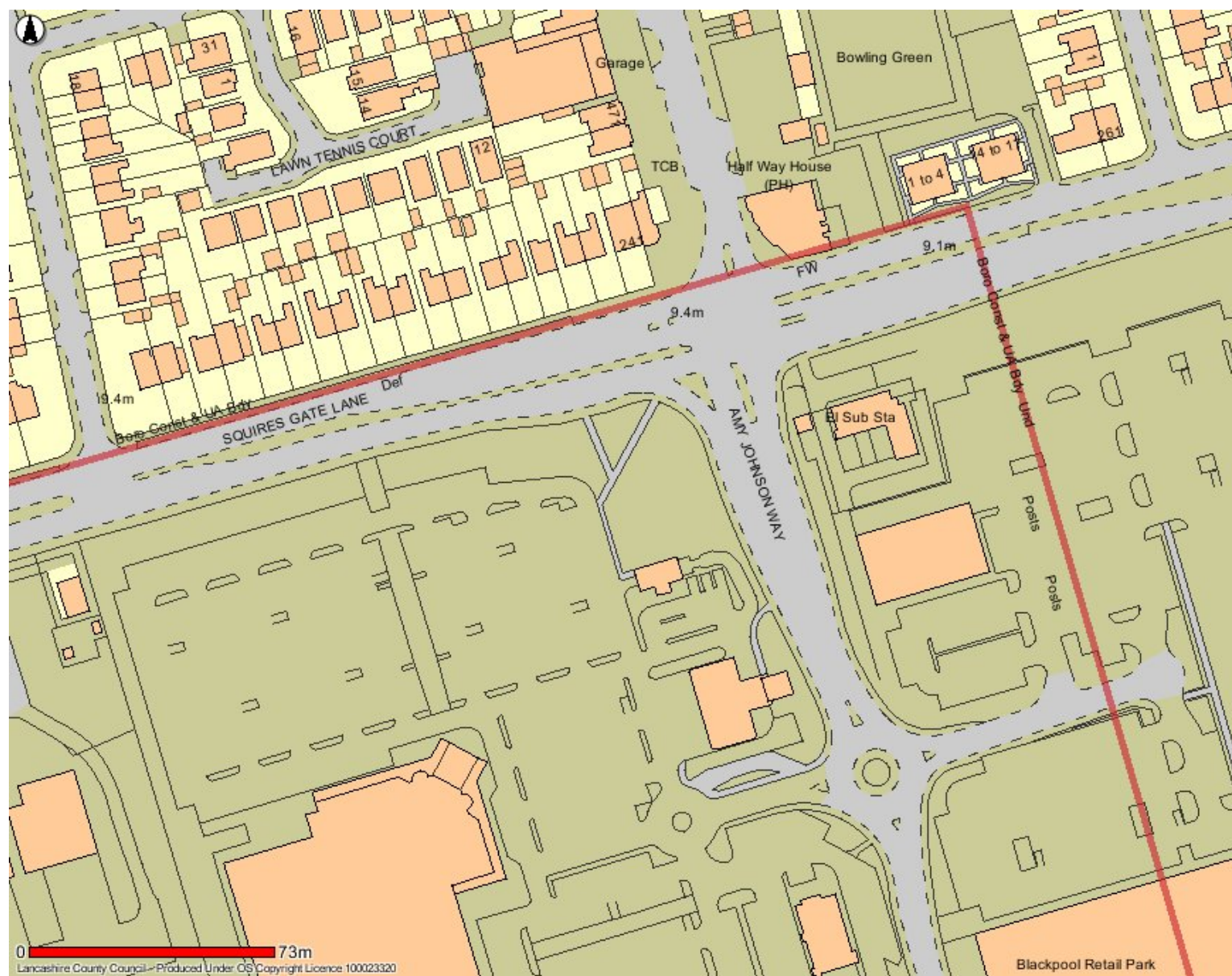

- Districts**
- Other District/Unitary Authority
  - Lancashire Districts

Morrisons Daily